



reform[®]
sports

20.000 Seats Stadium



HEADQUARTER - İSTANBUL/TÜRKİYE

REFORM SPORTS



[reformsports.com](https://www.reformsports.com)



info@reformsports.com



+90 212 533 70 73



FACTORY

TEKİRDAĞ/TÜRKİYE

- TURF PRODUCTION CAPACITY 11.000.000 M² / YEAR
- RUBBER PRODUCTION CAPACITY 300.000 M² / YEAR
- STEEL CONSTRUCTION CAPACITY 12.000 TON / YEAR

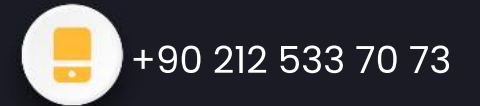

○ WE ARE LEADING ○

- **STADIUMS**
- **SPORTS ARENA**
- **TURN-KEY SPORTS COMPLEXES**
- **FIFA FOOTBALL FIELDS**
- **PROFESSIONAL FOOTBALL FIELDS**
- **HYBRID TURF FOOTBALL FIELDS**
- **ATHLETICS TRACKS**
- **METAL CONSTRUCTION**
- **INDOOR SPORTS COMPLEXES**
- **OUTDOOR SPORTS COMPLEXES**
- **PADEL COURTS**
- **FOOT 5 COURTS**
- **BASKETBALL, VOLLEYBALL, HANDBALL, TENNIS COURT**
- **HOCKEY, CRICKET FIELDS**
- **GOLF COURSES**
- **MULTISPORT FLOORING**
- **LANDSCAPING**
- **CHILDREN PLAY GROUNDS**

WHY REFORM SPORTS?

- OVER 30 YEARS OF EXPERIENCE
- TURN-KEY SOLUTIONS
- FLEXIBILITY AND FAST DELIVERY
- ENVIRONMENTALLY FRIENDLY
- RECYCLABLE MATERIALS
- HIGH QUALITY AND COMPETITIVE PRICES
- WARRANTY AND DURABILITY
- INTERNATIONALLY CERTIFIED



[reformsports.com](https://www.reformsports.com)



info@reformsports.com



+90 212 533 70 73



BRB
HOLDING

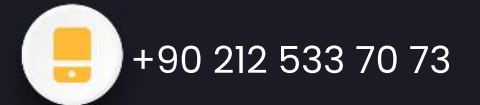

HIGHEST QUALITY

CERTIFIED BY INTERNATIONAL AUTHORITIES





7
REGIONS

105
COUNTRIES

15.000
PROJECTS

AFRICA

NIGERIA	NIJER	ETHIOPIA	SOUTH SUDAN
GANA	SIERRA LEONE	KENYA	MAURITIUS
SENEGAL	DEM. REP. OF CONGO	UGANDA	
IVORY COAST	CAMEROON	TANZANIA	
GAMBIA	KONGO	RWANDA	
MALI	GABON	MOZAMBIQUE	
GUINEA	CHAD	BURUNDI	
MAURITANIA	SOUTH AFRICA	DJIBOUTI	
BURKINA FASO	ZAMBIA	SOMALIA	
TOGO	SUDAN		

NORTH AFRICA

EGYPT
MOROCCO
TUNISIA
ALGERIA
LIBYA

ASSIA

RUSSIA	INDIA
AZERBAIJAN	MALAYSIA
TURKMENISTAN	PAKISTAN
UZBEKISTAN	BANGLADESH
AFGHANISTAN	PHILIPPINES
KAZAKHSTAN	HONG KONG
KYRGYZSTAN	ARMENIA
TAIIKISTAN	GEORGIA

AMERICA

USA	HAITI
CANADA	MARTINIQUE
PANAMA	GUYANA
CHILE	FRENCH GUIANA

EUROPE

GERMANY	UKRAINE	MALTA
FRANCE	POLAND	BELARUS
UK	PORTUGAL	
IRELAND	DENMARK	
ITALY	NORWAY	
SPAIN	MOLDOVA	
AUSTRIA	CZECH REPUBLIC	
NETHERLANDS	SLOVAKIA	
BELGIUM	LATVIA	

BALKANS

TÜRKİYE	CROATIA
BOSNIA	ALBANIA
BULGARIA	GREECE
ROMANIA	SERBIA
KOSOVO	SLOVENIA
MACEDONIA	MONTENEGRO

MIDDLE EAST

SAUDI ARABIA	BAHRAIN
KUWAIT	YEMEN
QATAR	LEBANON
UAE	JORDAN
OMAN	CYPRUS
IRAQ	KKTC

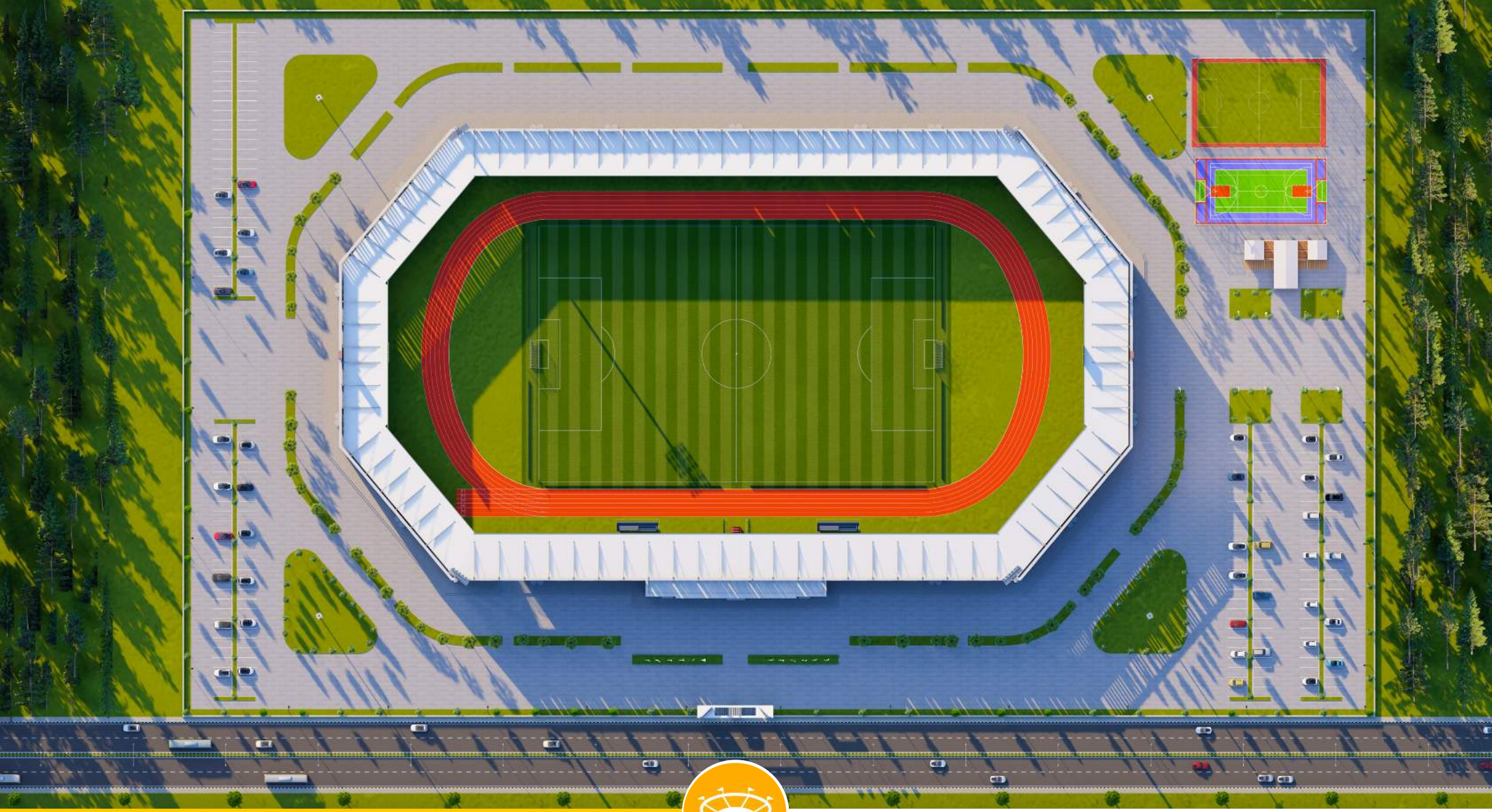

20.000 SEATS STADIUM



▶ STADIUM

- Football and athletics playgrounds in accordance with the FIFA and World Athletics standards
- Large circulation area on the ground floor that can accommodate the general public.
- Covered Tribunes, technical rooms, cafes and offices.



STADIUM

- 1 STANDARD FOOTBALL FIELD
- 2 ATHLETICS TRACK
- 3 TRIBUNES
- 4 MULTI-PURPOSE SPORTS FIELD
- 5 FOOTBALL TRAINING FIELD
- 6 COMMON SPACE
- 7 CAR PARKING AREA



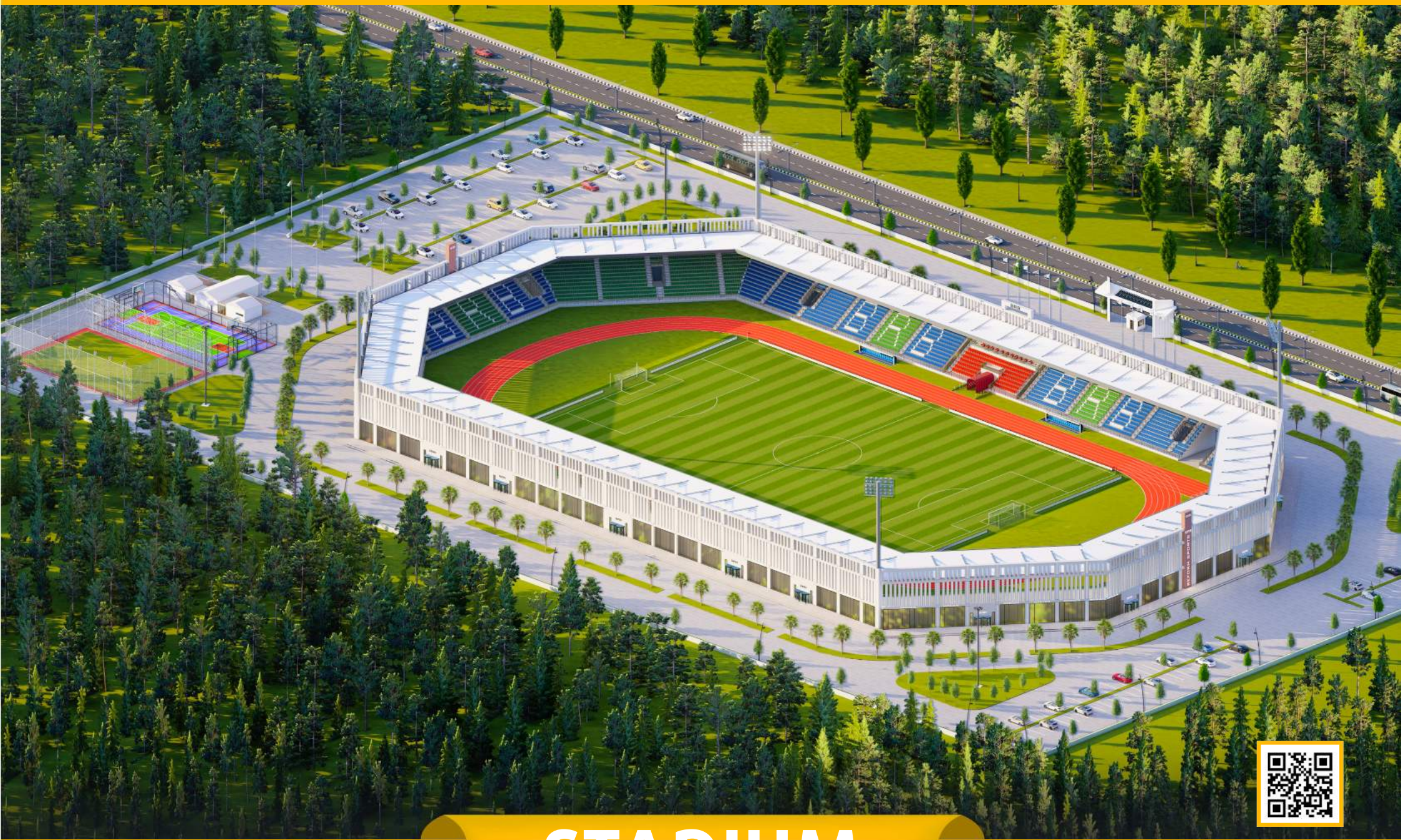

STADIUM



reformsports.com



info@reformsports.com



+90 212 533 70 73

STADIUM

TECHNICAL SPECIFICATIONS

- 30.000m² Total construction area
- 2.500m² indoor construction area
- 7.140m² FIFA standards football field
- 3.500 m² Sandwich system running track
- 30.000 seating capacity roofed tribunes
- 200 VIP Tribunes,
- 13 Protocol Tribunes
- 10 persons loca
- Goal post and nets,
- Corner poles
- Substitute benches
- Referee bench
- Ligthing system
- Led Score Board
- Fire system
- Emergency alert system
- Car parking area for 100 cars
- Sound system (Optional)

LIVING AREAS

- Cafeterias
- Fitnes center
- Locker rooms
- Referee locker rooms
- Public restrooms
- Disbaled restrooms
- Observers and representatives rooms
- Meeting rooms
- Facility supervisor room
- Staff rooms
- Security rooms
- Offices
- UPS room
- Electriciry controlling room
- Camera System (Optional)
- Card access control system (Optional)
- Generator (Optional)



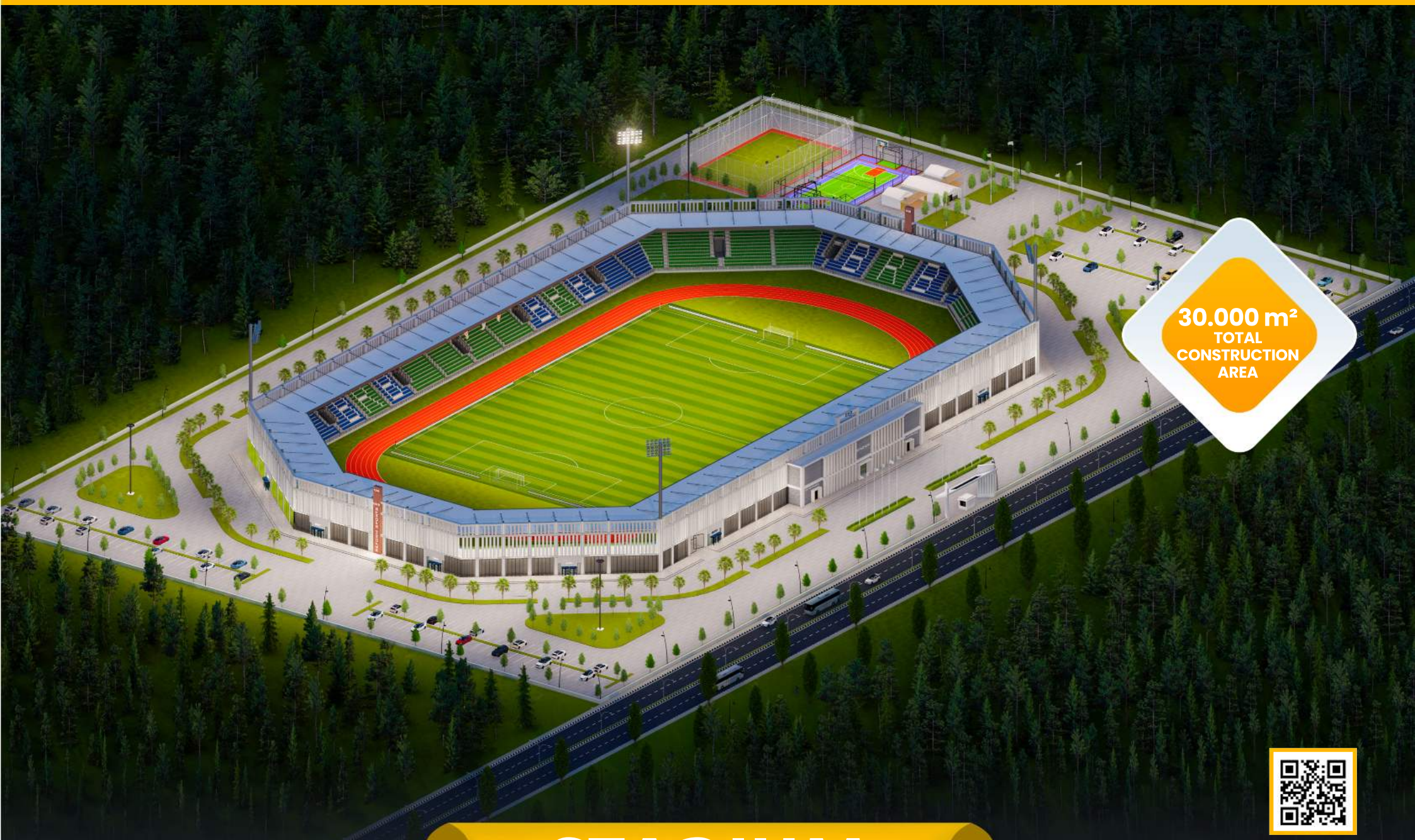

30.000 m²
TOTAL
CONSTRUCTION
AREA



STADIUM



reformsports.com



info@reformsports.com



+90 212 533 70 73



2.500 m²
INDOOR
AREA



STADIUM



reformsports.com



info@reformsports.com



+90 212 533 70 73



STADIUM



reformsports.com



info@reformsports.com



+90 212 533 70 73



FIFA
QUALITY
PRO



STANDARD FOOTBALL FIELD



reformsports.com



info@reformsports.com



+90 212 533 70 73

High Quality

Our products are produced with the highest quality, ethical standards and in accordance with the international standards



Resistant

Our abrasion and wear resistant products come with different heights, colour options and unique characteristics



Long Lasting

Artificial turfs are easy to maintain and cheap, as well as have a very long life with low maintenance



REFORM SPORTS' synthetic turf is produced with new generation monofilament yarns provides high-quality and provides maximum-performance for training and professional football pitches. Delays wear and tear due to modern yarn design and features. For many years; ball roll and bouncing and shock absorbing values remain in accordance with international standards. It doesn't reduce player's performance, it is environmentally friendly and recyclable.

ARTIFICIAL GRASS



Natural Appearance

It is produced with monofilament yarns for aesthetic and more natural appearance



High UV Resistance

It is produced with special UV resistant additive. Besides being resistant to UV rays, it is also resistant to cold weather



Nature Friendly

Our products are manufactured with environmental awareness and consist of recyclable materials with the use of effective technology and com-
pone



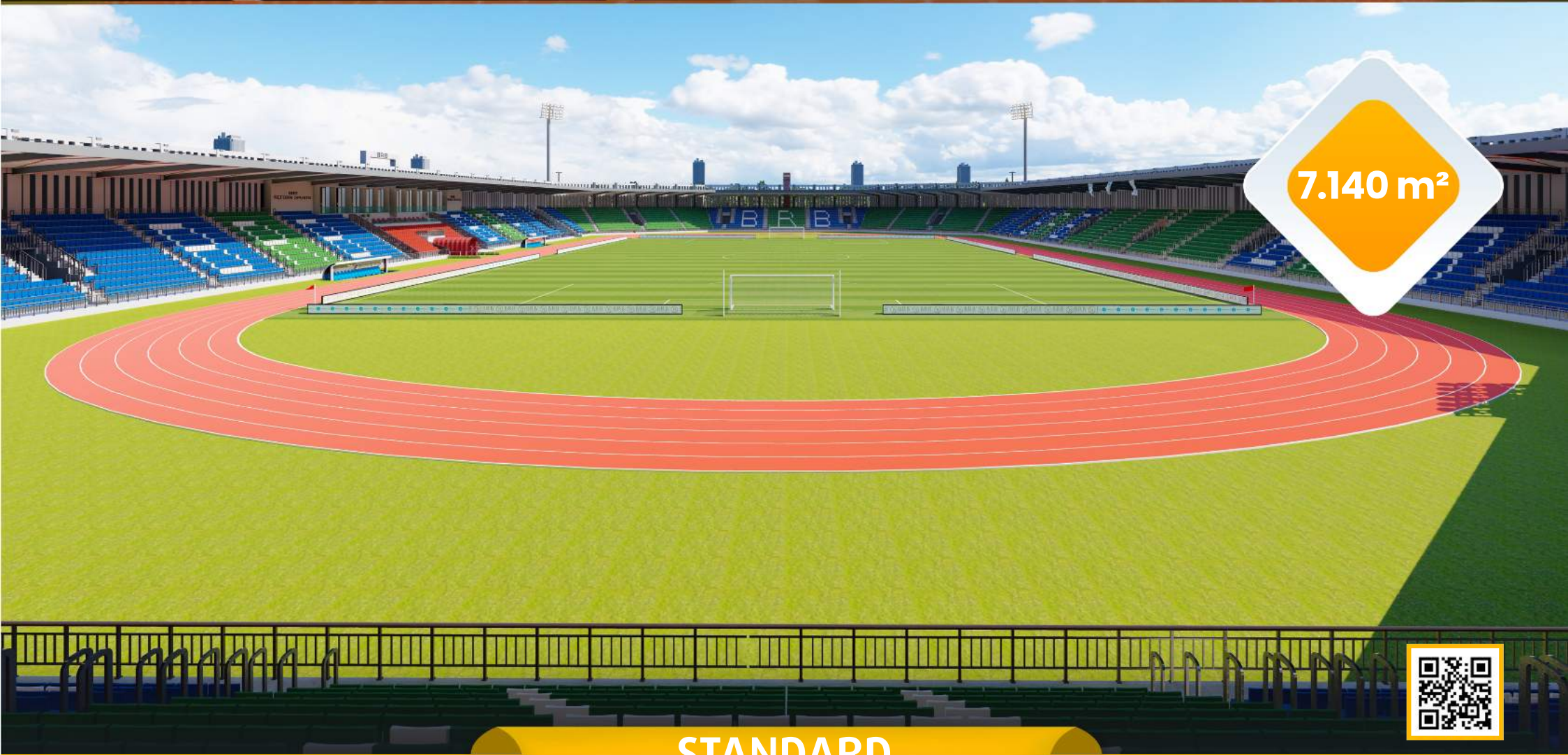

7.140 m²



STANDARD FOOTBALL FIELD



reformsports.com



info@reformsports.com



+90 212 533 70 73



**INTERNATIONAL
MATCH
STANDARD**

**FIFA
STANDARD
ARTIFICIAL
GRASS**



STANDARD FOOTBALL FIELD



reformsports.com



info@reformsports.com



+90 212 533 70 73



ATHLETICS TRACK



reformsports.com



info@reformsports.com



+90 212 533 70 73

High Quality

Our products are produced with the highest quality, ethical standards and in accordance with the international standards



Resistant

Our abrasion and wear resistant products come with different heights, colour options and unique characteristics



Long Lasting

Artificial turfs are easy to maintain and cheap, as well as have a very long life with low maintenance

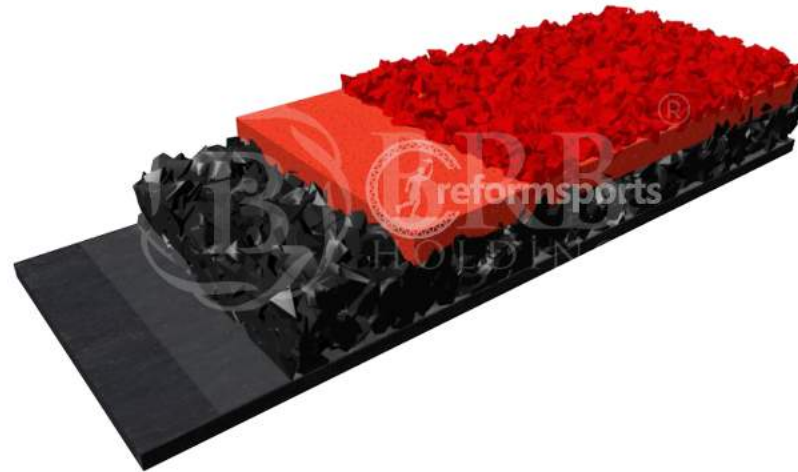

Natural Appearance

It is produced with monofilament yarns for aesthetic and more natural appearance



High UV Resistance

It is produced with special UV resistant additive. Besides being resistant to UV rays, it is also resistant to cold weather



Nature Friendly

Our products are manufactured with environmental awareness and consist of recyclable materials with the use of effective technology and components

Sandwich System Floor is durable, long lasting and resistant to all weather conditions. It can be used for international competitions. The system is water permeable and has shock absorbing. It is a ground resistant to puncture. The floor has a surface, which prevents slipping.



SANDWICH SYSTEM



reformsports.com



info@reformsports.com



+90 212 533 70 73



6 LANES
RUNNING
RACKS



ATHLETICS TRACK

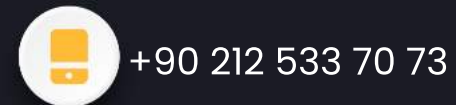

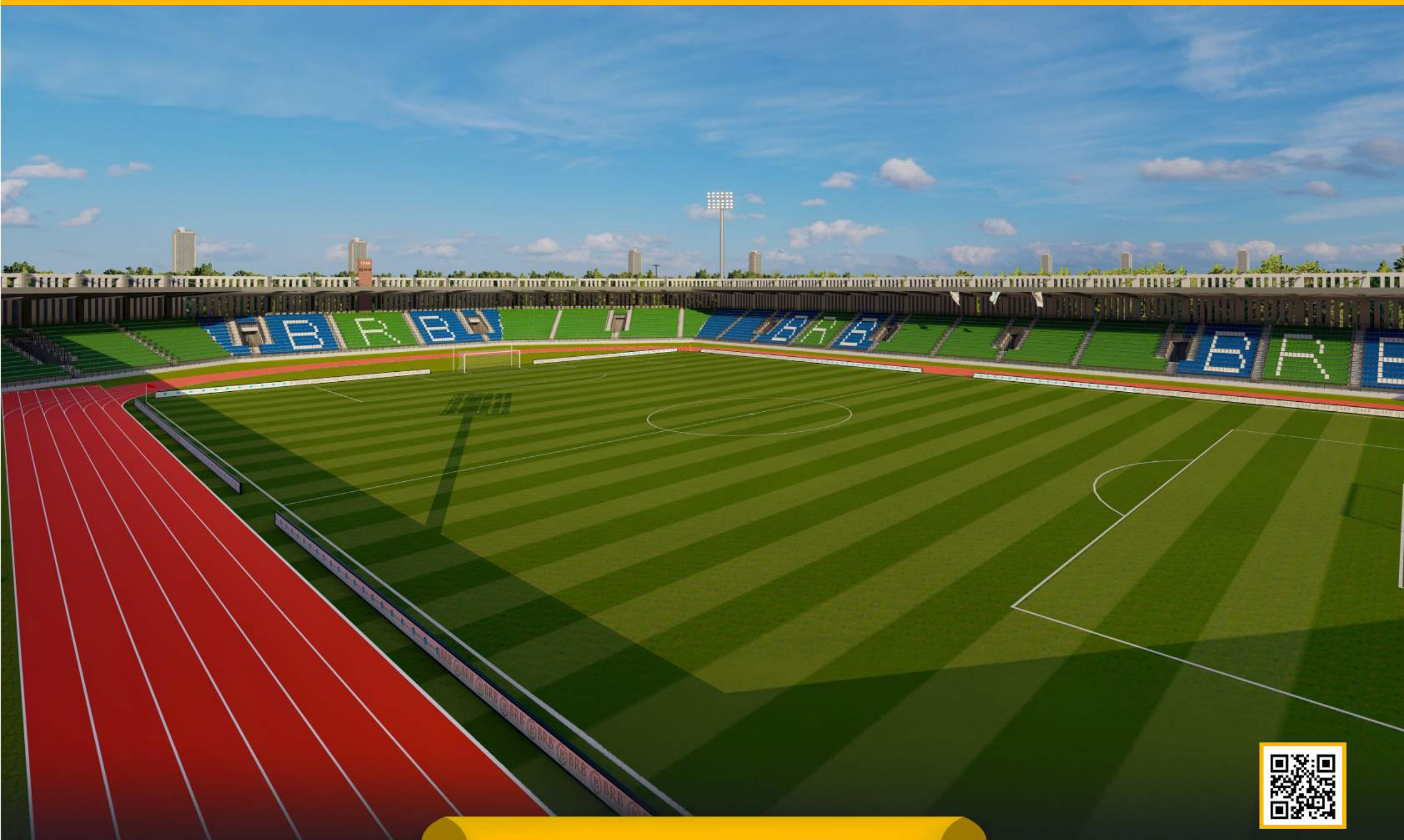

ATHLETICS TRACK



reformsports.com



info@reformsports.com



+90 212 533 70 73



20.000
SEATS
CAPACITY



TRIBUNES



reformsports.com



info@reformsports.com



+90 212 533 70 73



200 VIP SEATS



ERGONOMIC DESIGN



TRIBUNES



reformsports.com



info@reformsports.com



+90 212 533 70 73

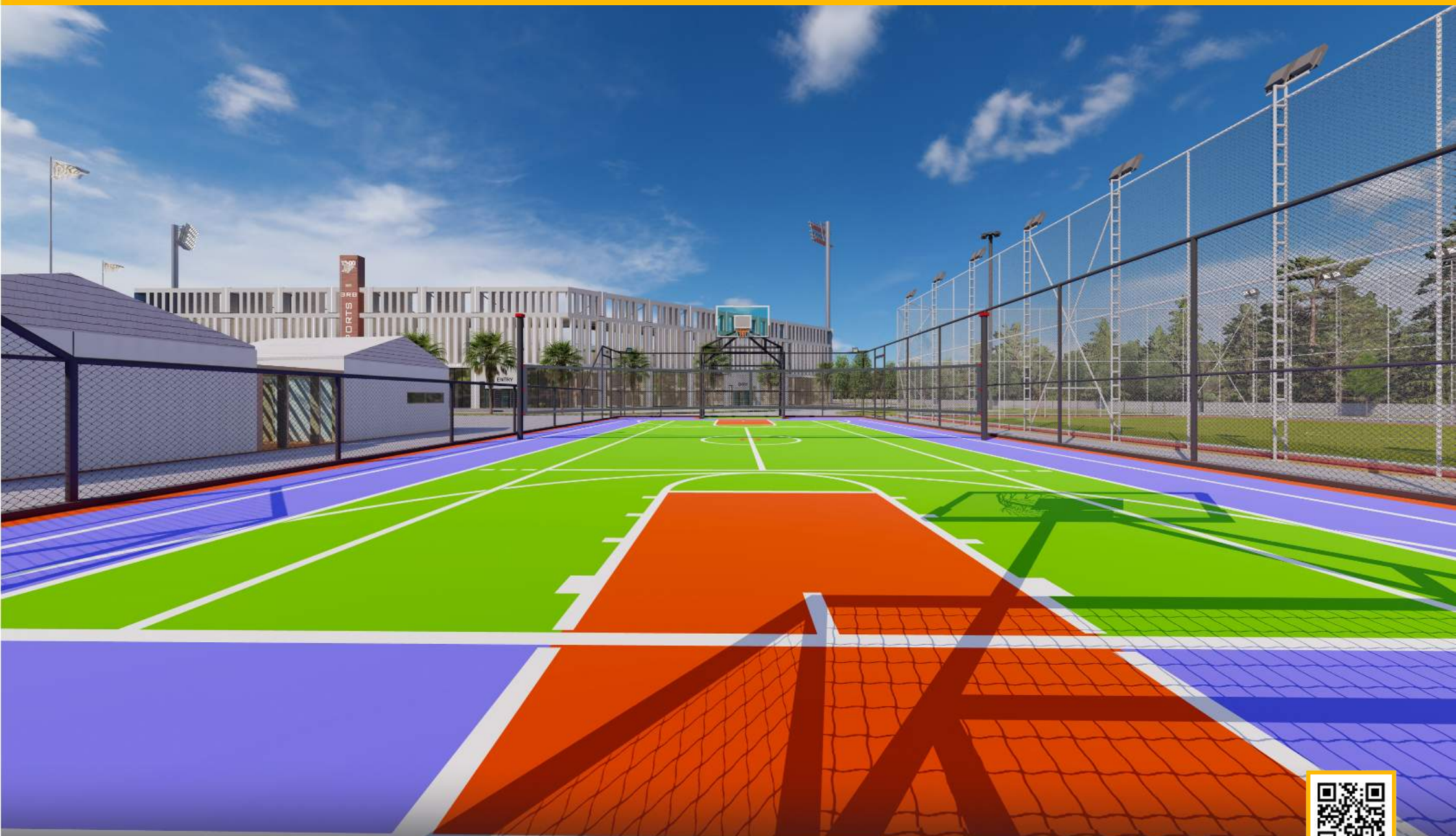

MULTI-PURPOSE SPORTS FIELD



reformsports.com



info@reformsports.com



+90 212 533 70 73

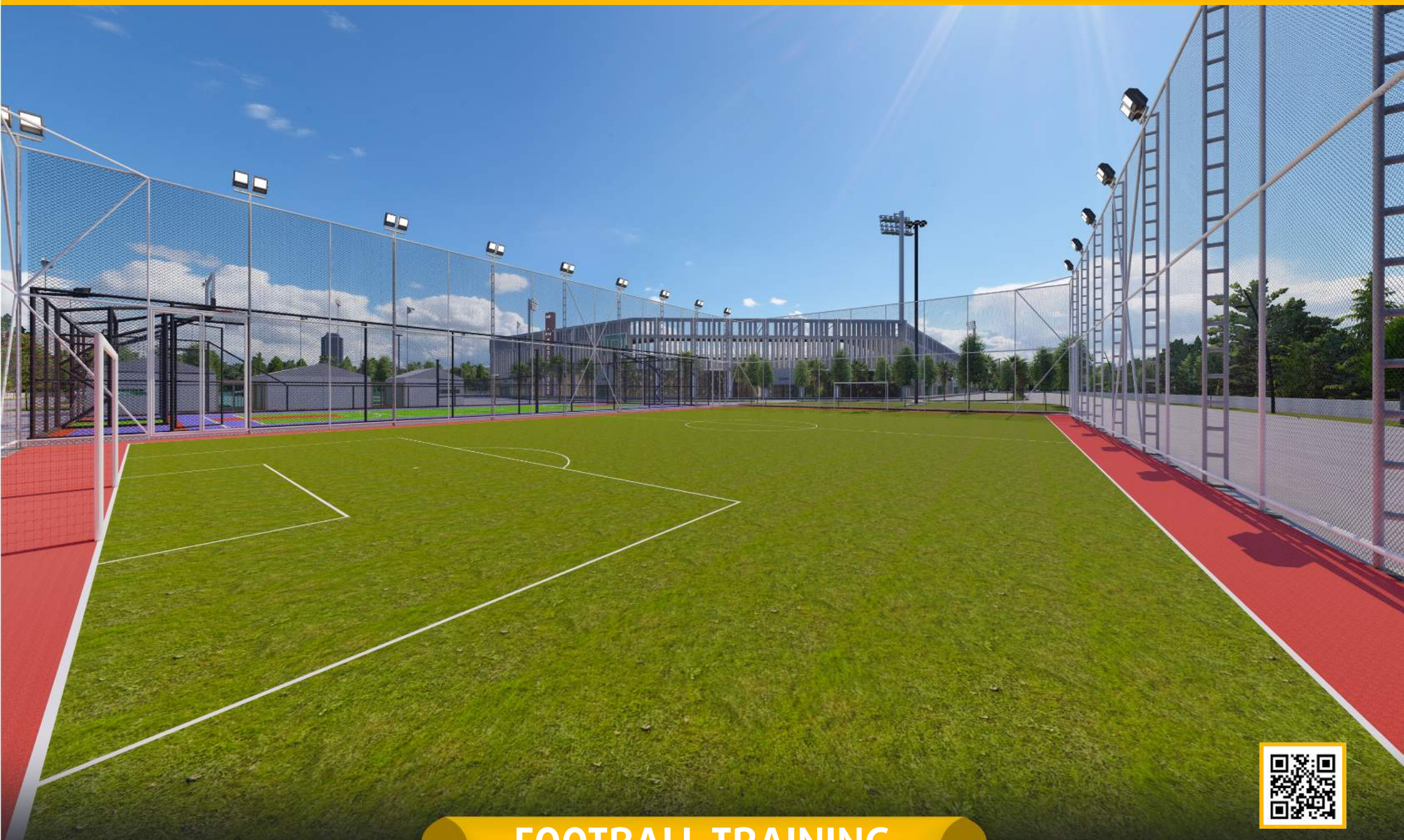

FOOTBALL TRAINING FIELD



reformsports.com



info@reformsports.com



+90 212 533 70 73



750 m²



INTERIOR

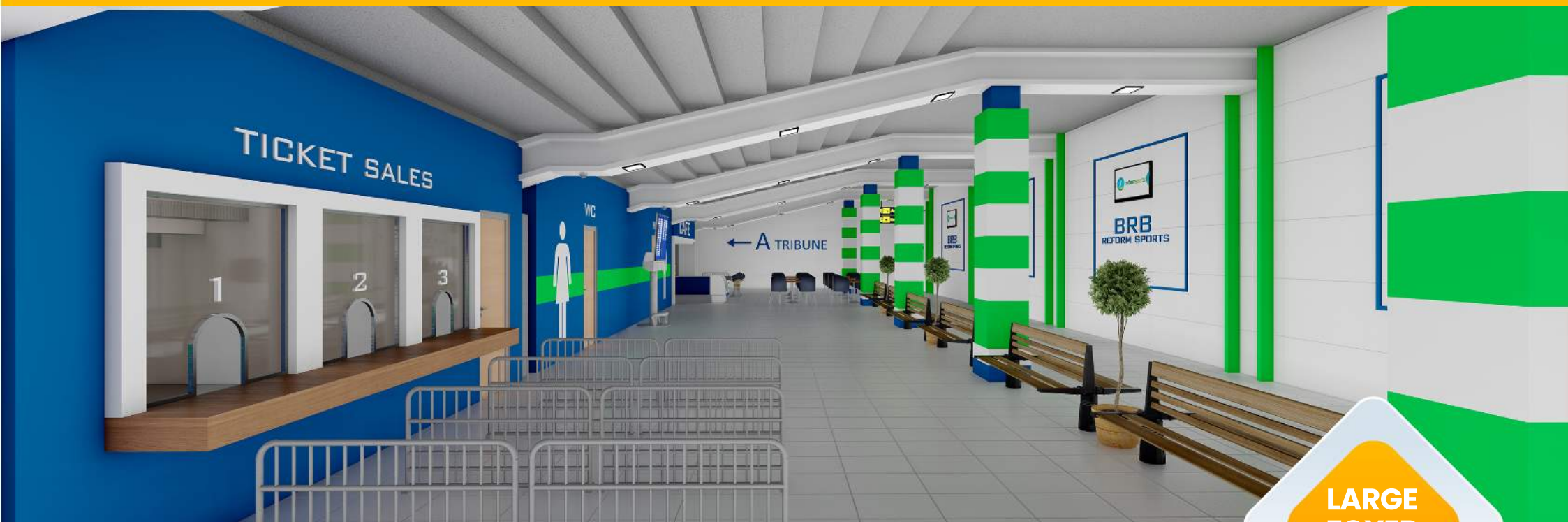

LARGE
FOYER
AREA



INTERIOR

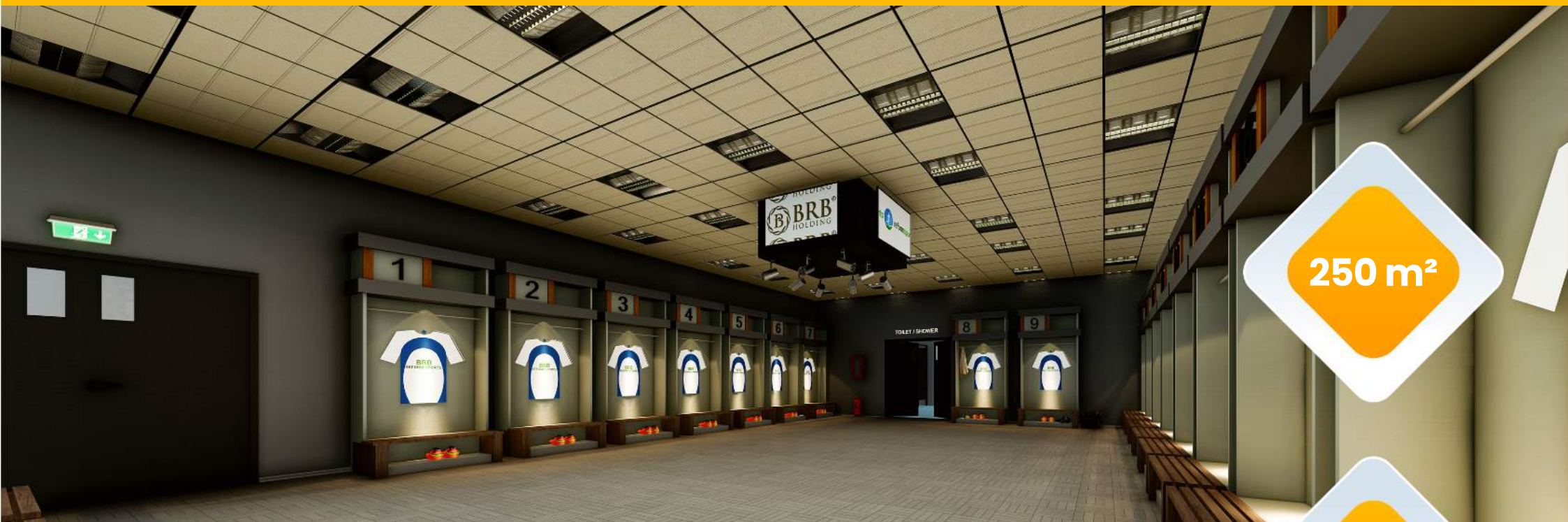

250 m²



2 FOR
TEAMS

LOCKER ROOM

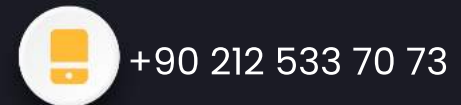



120 M²
FOR
TEAMS



WC & BATHROOM



[reformsports.com](https://www.reformsports.com)



info@reformsports.com



+90 212 533 70 73



40 m²

MEDICAL ROOM



reformsports.com



info@reformsports.com



+90 212 533 70 73

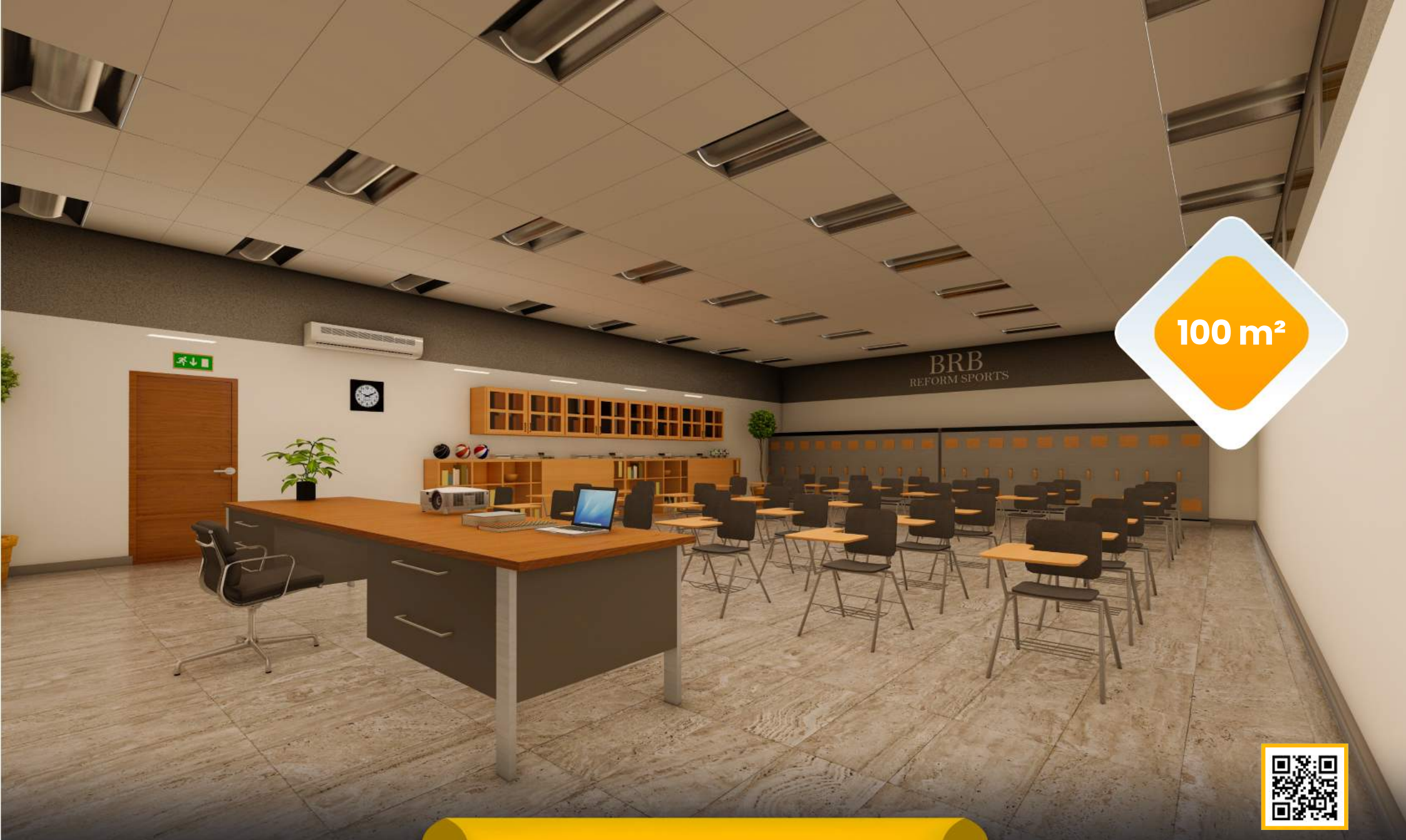

100 m²



SPORTS ACADEMY



reformsports.com



info@reformsports.com



+90 212 533 70 73



REFEREE ROOM



[reformsports.com](https://www.reformsports.com)



info@reformsports.com



+90 212 533 70 73



BRB
REFORM SPORTS

40 m²



LOCKER ROOM

BRB
REFORM SPORTS



**TECHNICAL DIRECTOR'S
ROOM**

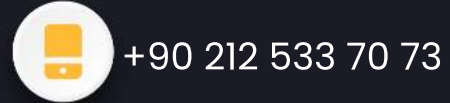



PRESS AND MEETING ROOM



reformsports.com



info@reformsports.com



+90 212 533 70 73



120 m²

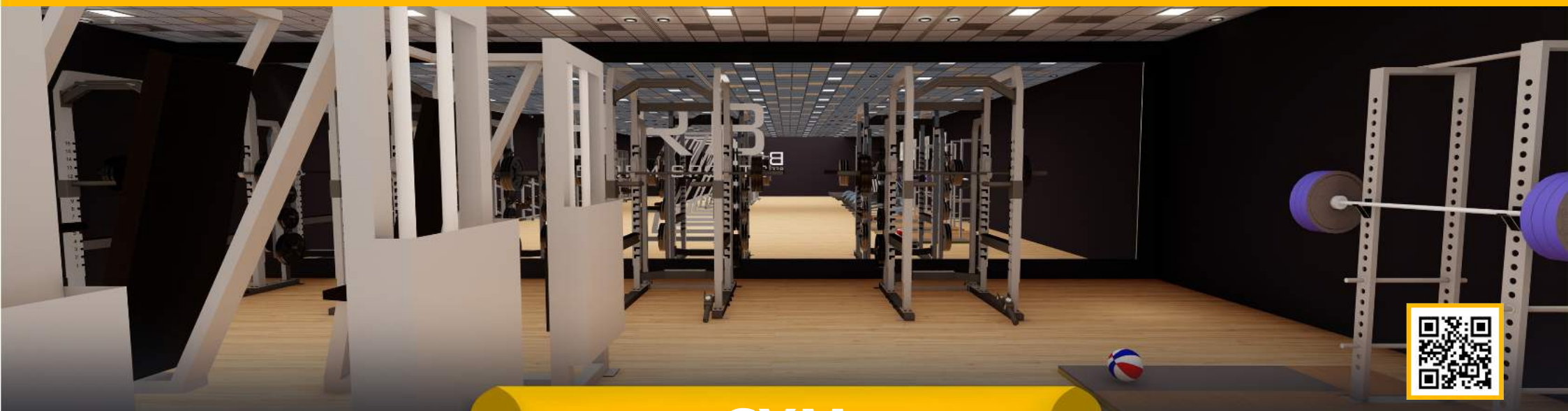

GYM



reformsports.com



info@reformsports.com



+90 212 533 70 73

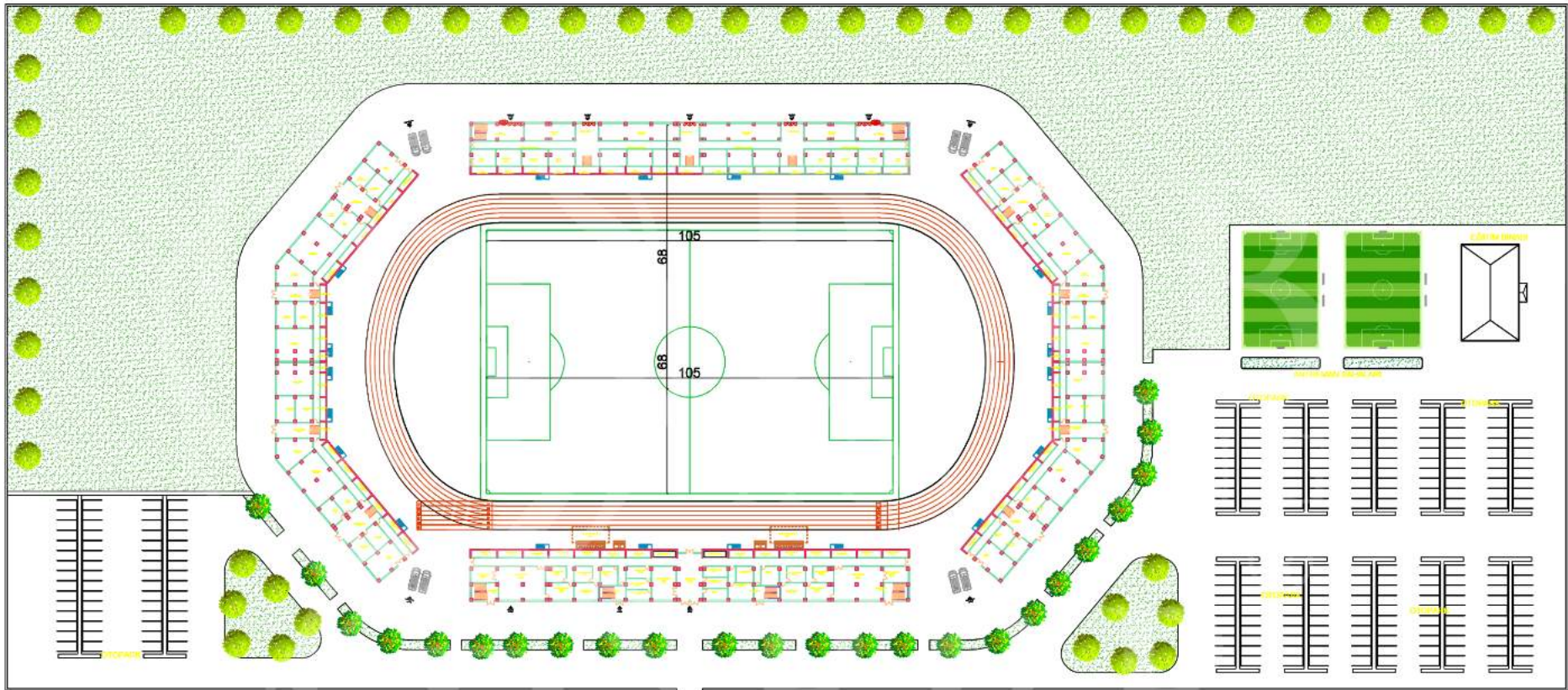

GENERAL LAYOUT ARCHITECTURAL PLAN



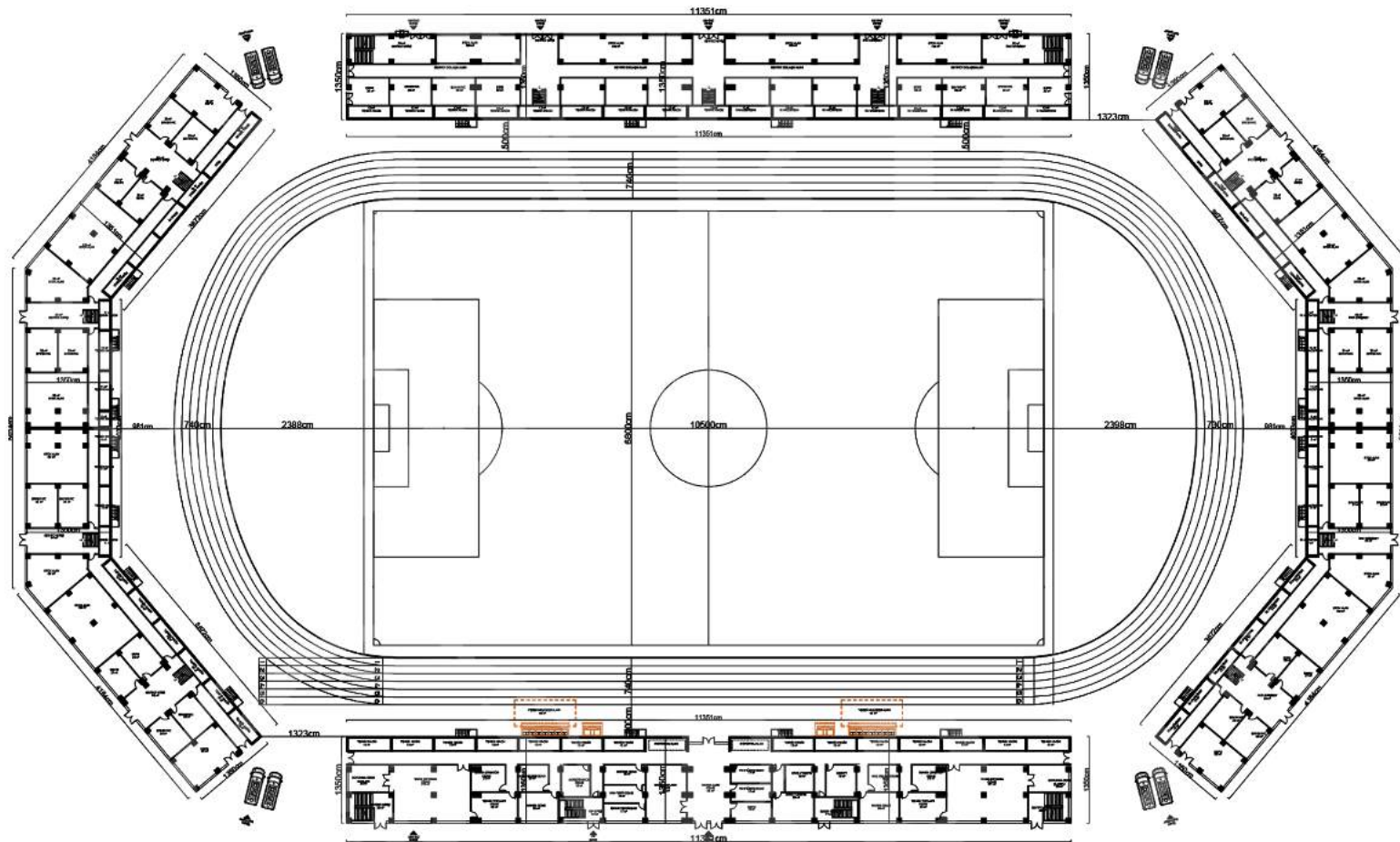

GROUND FLOOR ARCHITECTURAL PLAN



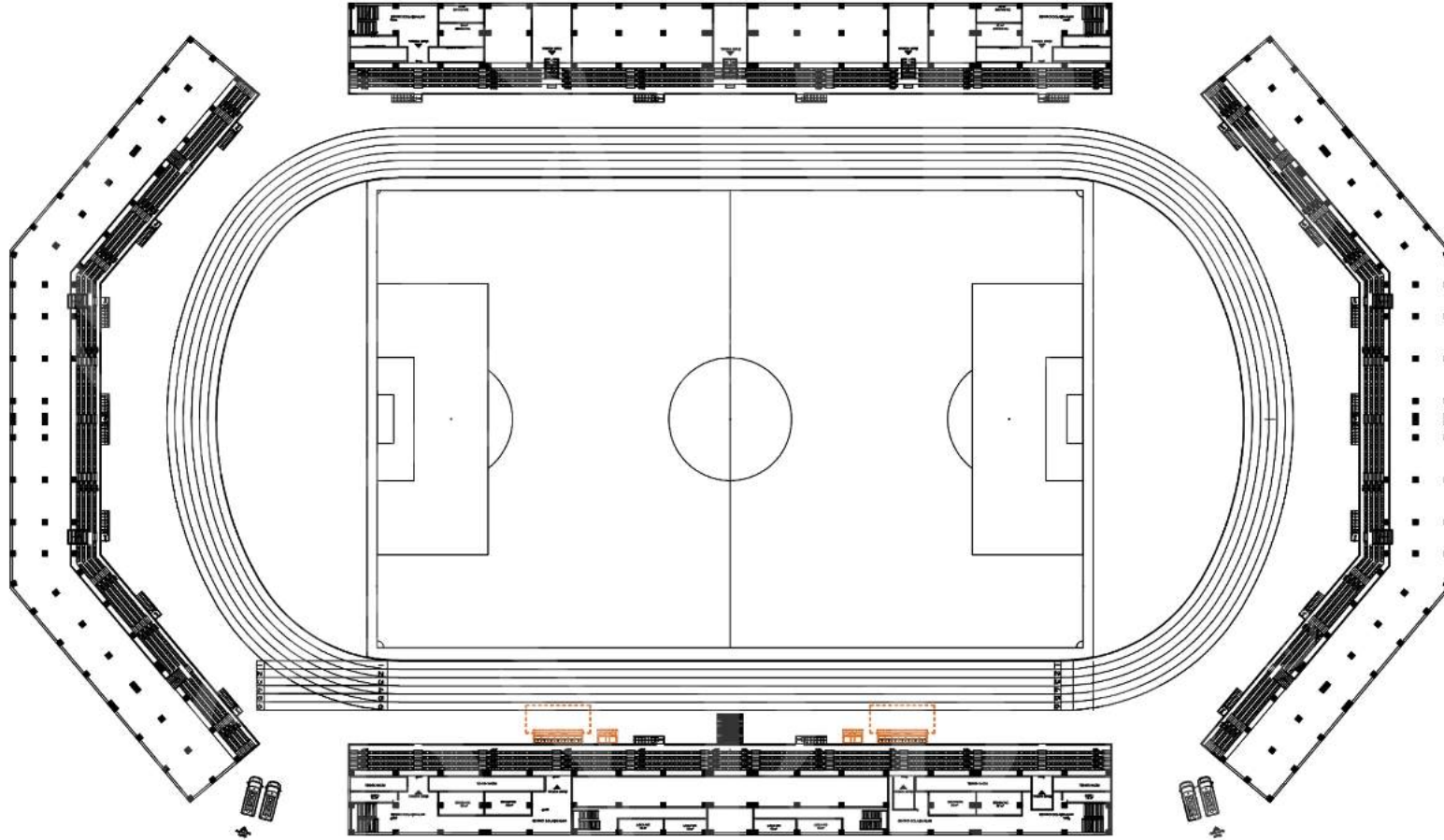

FIRST FLOOR ARCHITECTURAL PLAN



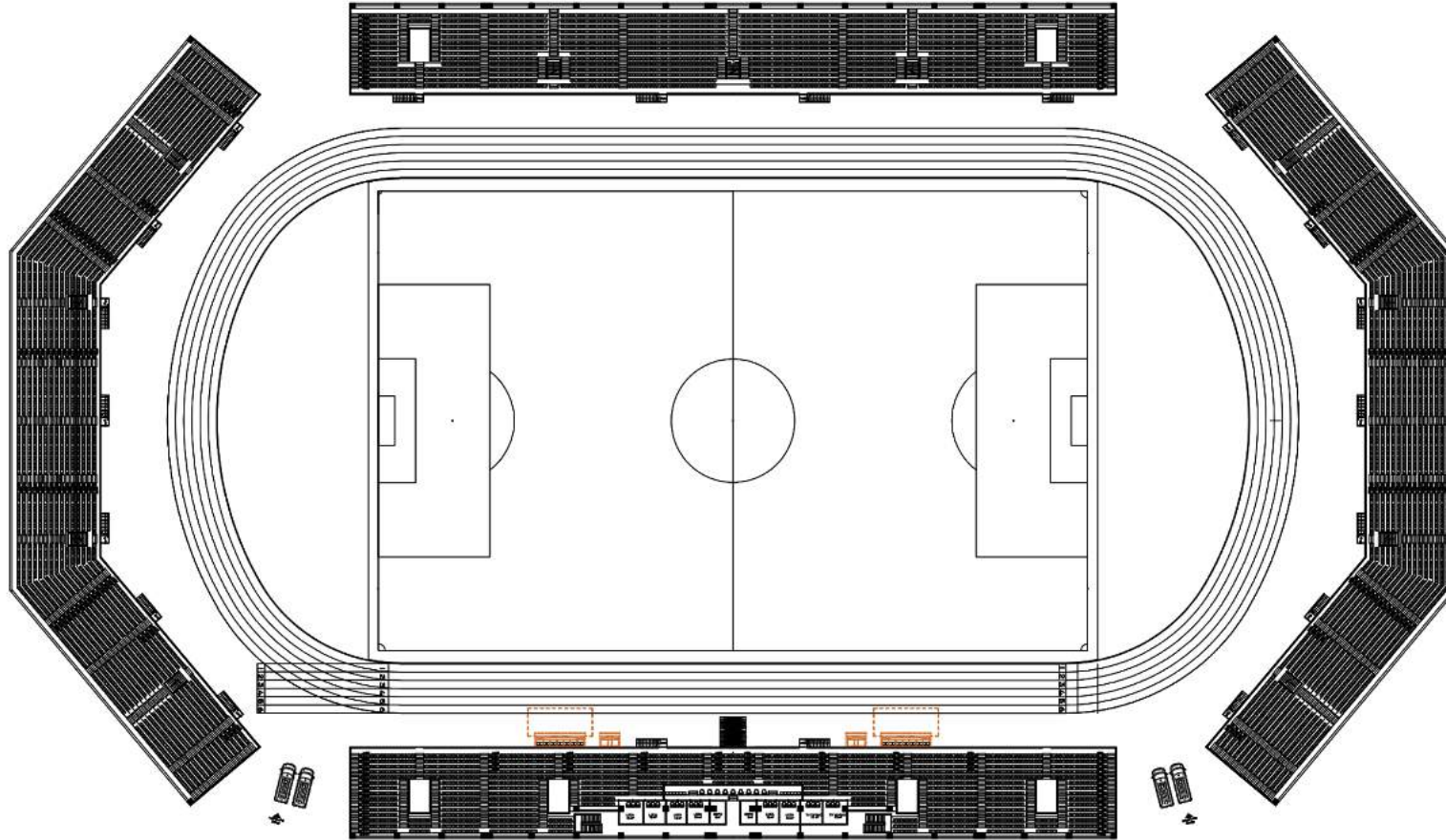

TRIBUNES

ARCHITECTURAL PLAN



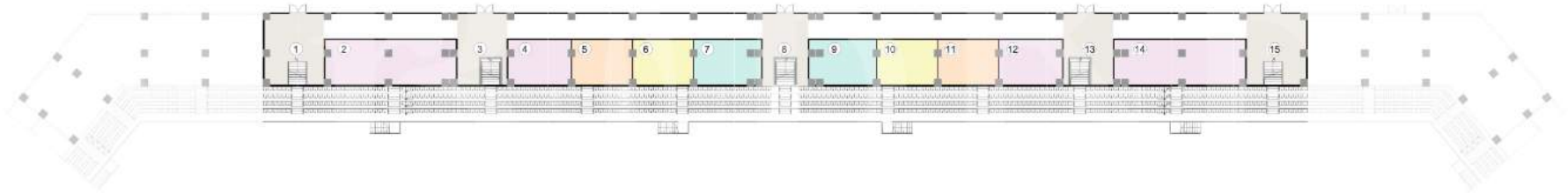

NUMBER/ SAYI	COLOUR/ RENK	SQUARE METERS/ METREKARE	VENUE NAME/ MAHAL ADI
2		65.00 m ²	Store Depo
3		33.00 m ²	Audience Entry Seyirci Girişi
4		31.00 m ²	Store Depo
5		30.00 m ²	Buffet Büfe
6		30.00 m ²	Woman's wc Bayan wc
7		32.60 m ²	Male's wc Erkek wc
8		30.00 m ²	Audience Entry Seyirci Girişi
9		32.60 m ²	Male's wc Erkek wc
10		30.00 m ²	Woman's wc Bayan wc
11		30.00 m ²	Buffet Büfe
12		31.00 m ²	Store Depo
13		33.00 m ²	Audience Entry Seyirci Girişi
14		65.00 m ²	Store Depo
15		47.00 m ²	Audience Entry Seyirci Girişi

TRIBUNES

ARCHITECTURAL PLAN



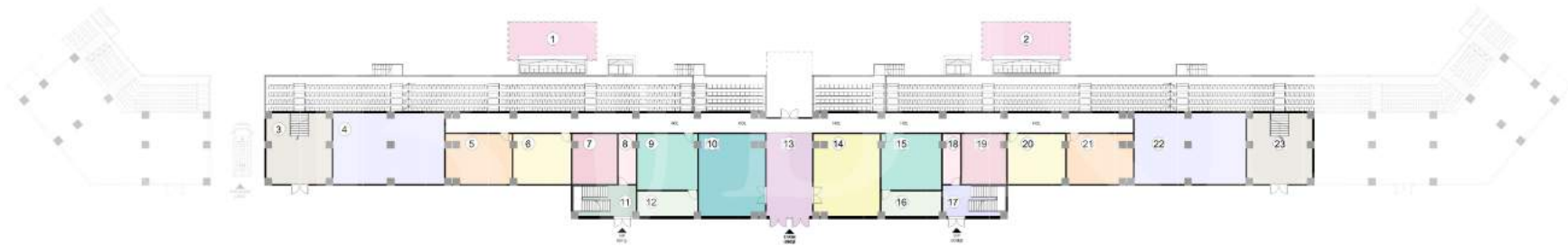

	NUMBER/ SAYI	COLOUR/ RENK	SQUARE METERS/ METREKARE	VENUE NAME/ MAHAL ADI		NUMBER/ SAYI	COLOUR/ RENK	SQUARE METERS/ METREKARE	VENUE NAME/ MAHAL ADI	
	MARATON TRIBÜNÜ	1		55.00 m ²		Reserve Bench Area Yedek Kulübesi Alanı	MARATON TRIBÜNÜ	16		17.00 m ²
2			55.00 m ²	Reserve Bench Area Yedek Kulübesi Alanı	17			10.00 m ²	Press Entrance Basın Girişi	
3			46.00 m ²	Audience Entry Seyirci Girişi	18			10.00 m ²	Stair Hall Merdiven Holü	
4			90.00 m ²	Changing rooms-Showers Boyunma odası ve Duşlar	19			25.00 m ²	Accreditation's Room Akrediteasyon Odası	
5			36.00 m ²	Team Dressing Room Takım Soyunma Odası	20			33.00 m ²	Technical Director's Room Teknik Direktör Odası	
6			33.00 m ²	Technical Director's Room Teknik Direktör Odası	21			36.00 m ²	Team Dressing Room Takım Soyunma Odası	
7			25.00 m ²	Accreditation's Room Akrediteasyon Odası	22			90.00 m ²	Changing rooms-Showers Boyunma odası ve Duşlar	
8			10.00 m ²	Stair Hall Merdiven Holü	23			46.00 m ²	Audience Entry Seyirci Girişi	
9			38.00 m ²	Blood Test Room Kan Testi Odası						
10			61.00 m ²	Press Conference Room Basın Toplantısı Odası						
11			10.00 m ²	VIP Entrance VIP Girişi						
12			17.00 m ²	Urine Test Room İdrar Testi Odası						
13			44.00 m ²	Mixed Field Karma Alan						
14			61.00 m ²	Mosque Mescit						
15			38.00 m ²	Blood Test Room Kan Testi Odası						

TRIBUNES

ARCHITECTURAL PLAN



KALE ARKASI GÜNEY/ CASTLE BACK SOUTH

NUMBER/ SAYI	COLOUR/ RENK	SQUARE METERS/ METREKARE	VENUE NAME/ MAHAL ADI	NUMBER/ SAYI	COLOUR/ RENK	SQUARE METERS/ METREKARE	VENUE NAME/ MAHAL ADI
1		200.00 m ²	Store Depo	13		64.00 m ²	Stock Area Stok Alan
2		17.00 m ²	Male's wc Erkek wc	14		20.00 m ²	Male's wc Erkek wc
3		25.95 m ²	Woman's wc Bayan wc	15		29.65 m ²	Woman's wc Bayan wc
4		36.00 m ²	Audience Entry Seyirci Girişi	16		25.80 m ²	Audience Entry Seyirci Girişi
5		16.50 m ²	Infirmary Revir	17		42.00 m ²	Stock Area Stok Alan
6		26.00 m ²	Buffet Bufo	18		88.00 m ²	Stock Area Stok Alan
7		88.00 m ²	Stock Area Stok Alan	19		26.00 m ²	Buffet Bufo
8		42.00 m ²	Stock Area Stok Alan	20		16.50 m ²	Infirmary Revir
9		25.80 m ²	Audience Entry Seyirci Girişi	21		38.00 m ²	Audience Entry Seyirci Girişi
10		20.00 m ²	Male's wc Erkek wc	22		17.00 m ²	Male's wc Erkek wc
11		29.65 m ²	Woman's wc Bayan wc	23		25.95 m ²	Woman's wc Bayan wc
12		64.00 m ²	Stock Area Stok Alan	24		200.00 m ²	Store Depo

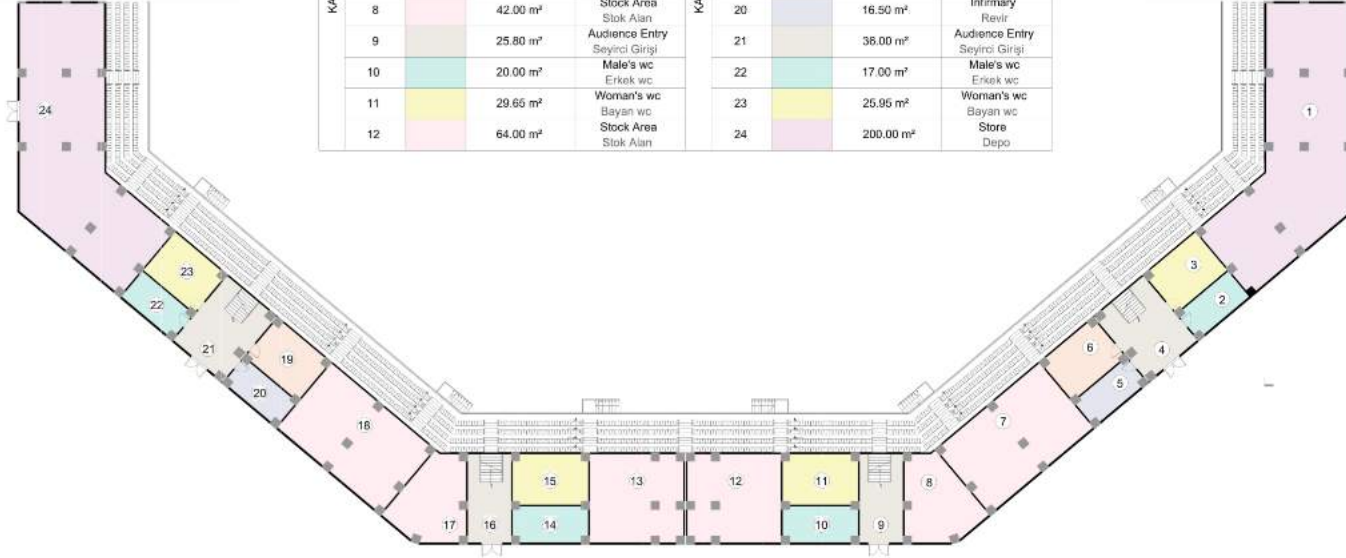

TOPLAM NET ALAN / TOTAL NET AREA 1.181.30 m²

TRIBUNES ARCHITECTURAL PLAN



KALE ARKASI KUZEY/ CASTLE BACK NORTH

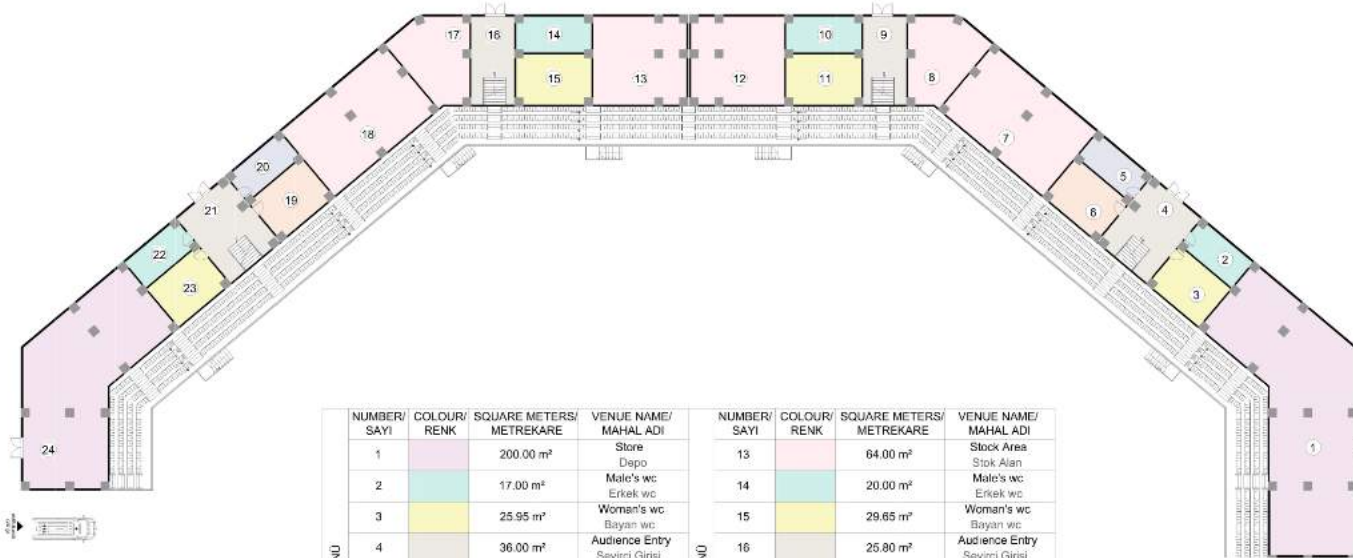

	NUMBER/ SAYI	COLOUR/ RENK	SQUARE METERS/ METREKARE	VENUE NAME/ MAHAL ADI		NUMBER/ SAYI	COLOUR/ RENK	SQUARE METERS/ METREKARE	VENUE NAME/ MAHAL ADI
KALE ARKASI TRIBÜNDÜ	1		200.00 m ²	Store Dapo	KALE ARKASI TRIBÜNDÜ	13		64.00 m ²	Stock Area Stok Alan
	2		17.00 m ²	Male's wc Erkek wc		14		20.00 m ²	Male's wc Erkek wc
	3		25.95 m ²	Woman's wc Bayan wc		15		29.65 m ²	Woman's wc Bayan wc
	4		36.00 m ²	Audience Entry Seyirci Girişi		16		25.80 m ²	Audience Entry Seyirci Girişi
	5		16.50 m ²	Infirmary Revir		17		42.00 m ²	Stock Area Stok Alan
	6		26.00 m ²	Buffet Büfe		18		88.00 m ²	Stock Area Stok Alan
	7		88.00 m ²	Stock Area Stok Alan		19		26.00 m ²	Buffet Büfe
	8		42.00 m ²	Stock Area Stok Alan		20		16.50 m ²	Infirmary Revir
	9		25.80 m ²	Audience Entry Seyirci Girişi		21		36.00 m ²	Audience Entry Seyirci Girişi
	10		20.00 m ²	Male's wc Erkek wc		22		17.00 m ²	Male's wc Erkek wc
	11		29.65 m ²	Woman's wc Bayan wc		23		25.95 m ²	Woman's wc Bayan wc
	12		64.00 m ²	Stock Area Stok Alan		24		154.00 m ²	Store Depo

TOPLAM NET ALAN / TOTAL NET AREA 1.181.30 m²

TRIBUNES ARCHITECTURAL PLAN





reform[®]
sports



www.reformsports.com