



reform[®]
sports

*2.000 Seats Stadium
With Running Tracks*



HEADQUARTER - İSTANBUL/TÜRKİYE

REFORM SPORTS



[reformsports.com](https://www.reformsports.com)



info@reformsports.com



+90 212 533 70 73



FACTORY

TEKİRDAĞ/TÜRKİYE

TURF PRODUCTION CAPACITY 11.000.000 M² / YEAR •

RUBBER PRODUCTION CAPACITY 300.000 M² / YEAR •

STEEL CONSTRUCTION CAPACITY 12.000 TON / YEAR •

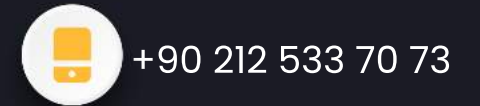

○ WE ARE LEADING ○

- **STADIUMS**
- **SPORTS ARENA**
- **TURN-KEY SPORTS COMPLEXES**
- **FIFA FOOTBALL FIELDS**
- **PROFESSIONAL FOOTBALL FIELDS**
- **HYBRID TURF FOOTBALL FIELDS**
- **ATHLETICS TRACKS**
- **METAL CONSTRUCTION**
- **INDOOR SPORTS COMPLEXES**
- **OUTDOOR SPORTS COMPLEXES**
- **PADEL COURTS**
- **FOOT 5 COURTS**
- **BASKETBALL, VOLLEYBALL, HANDBALL, TENNIS COURT**
- **HOCKEY, CRICKET FIELDS**
- **GOLF COURSES**
- **MULTISPORT FLOORING**
- **LANDSCAPING**
- **CHILDREN PLAY GROUNDS**

WHY REFORM SPORTS?

- OVER 30 YEARS OF EXPERIENCE
- TURN-KEY SOLUTIONS
- FLEXIBILITY AND FAST DELIVERY
- ENVIRONMENTALLY FRIENDLY
- RECYCLABLE MATERIALS
- HIGH QUALITY AND COMPETITIVE PRICES
- WARRANTY AND DURABILITY
- INTERNATIONALLY CERTIFIED



[reformsports.com](https://www.reformsports.com)



info@reformsports.com



+90 212 533 70 73



BRB
HOLDING

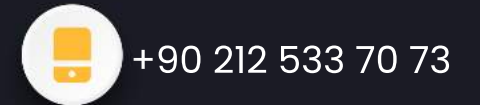

HIGHEST QUALITY

CERTIFIED BY INTERNATIONAL AUTHORITIES





7
REGIONS

105
COUNTRIES

15.000
PROJECTS

AFRICA

NIGERIA	NIJER	ETHIOPIA	SOUTH SUDAN
GANA	SIERRA LEONE	KENYA	MAURITIUS
SENEGAL	DEM. REP. OF CONGO	UGANDA	
IVORY COAST	CAMEROON	TANZANIA	
GAMBIA	KONGO	RWANDA	
MALI	GABON	MOZAMBIQUE	
GUINEA	CHAD	BURUNDI	
MAURITANIA	SOUTH AFRICA	DJIBOUTI	
BURKINA FASO	ZAMBIA	SOMALIA	
TOGO	SUDAN		

NORTH AFRICA

EGYPT
MOROCCO
TUNISIA
ALGERIA
LIBYA

ASSIA

RUSSIA	INDIA
AZERBAIJAN	MALAYSIA
TURKMENISTAN	PAKISTAN
UZBEKISTAN	BANGLADESH
AFGHANISTAN	PHILIPPINES
KAZAKHSTAN	HONG KONG
KYRGYZSTAN	ARMENIA
TAIIKISTAN	GEORGIA

AMERICA

USA	HAITI
CANADA	MARTINIQUE
PANAMA	GUYANA
CHILE	FRENCH GUIANA

EUROPE

GERMANY	UKRAINE	MALTA
FRANCE	POLAND	BELARUS
UK	PORTUGAL	
IRELAND	DENMARK	
ITALY	NORWAY	
SPAIN	MOLDOVA	
AUSTRIA	CZECH REPUBLIC	
NETHERLANDS	SLOVAKIA	
BELGIUM	LATVIA	

BALKANS

TÜRKIYE	CROATIA
BOSNIA	ALBANIA
BULGARIA	GREECE
ROMANIA	SERBIA
KOSOVO	SLOVENIA
MACEDONIA	MONTENEGRO

MIDDLE EAST

SAUDI ARABIA	BAHRAIN
KUWAIT	YEMEN
QATAR	LEBANON
UAE	JORDAN
OMAN	CYPRUS
IRAQ	KKTC

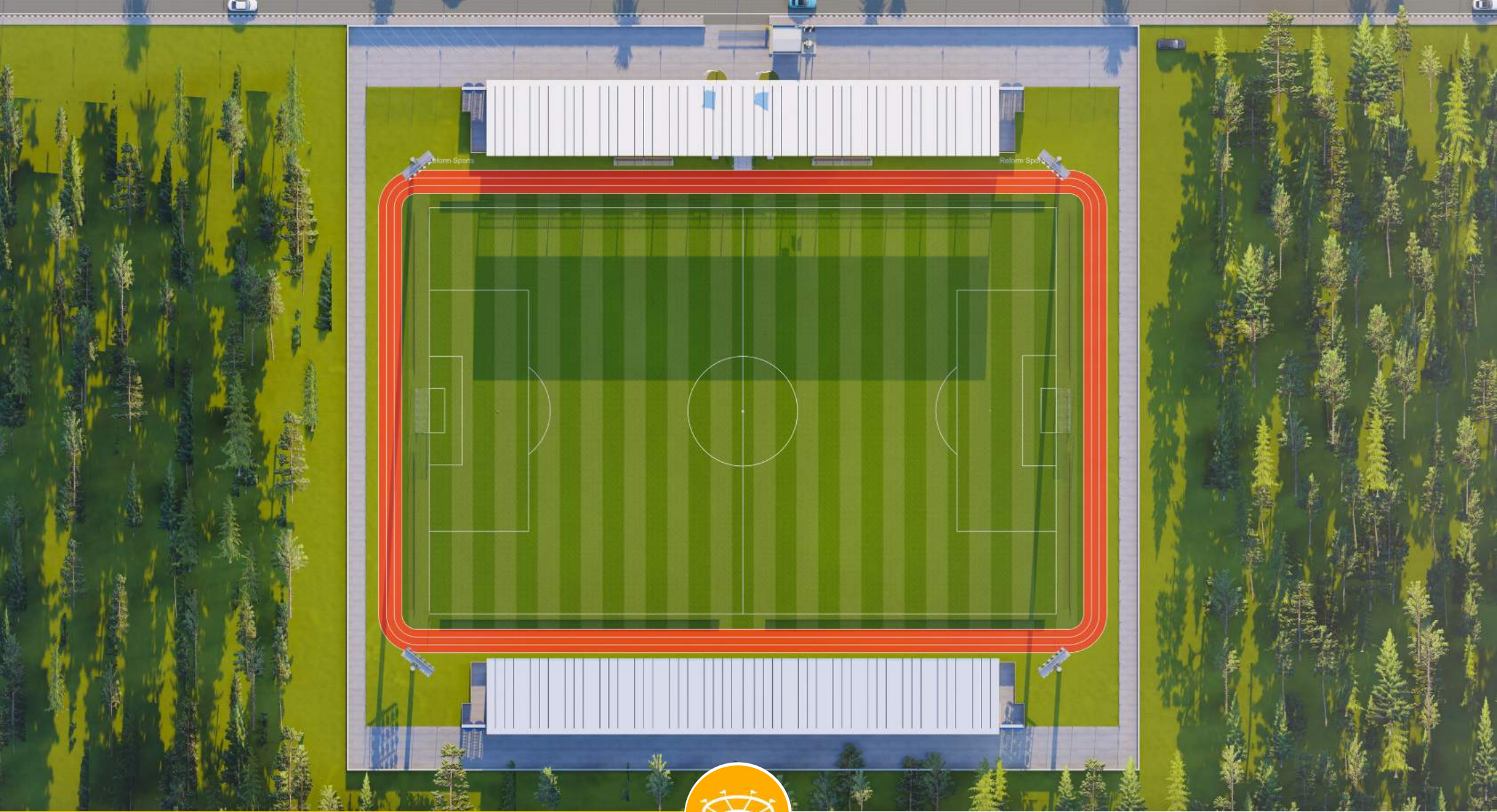

SCENARIO 2



▶ STADIUM

- FIFA Football Field and running track
- Large circulation area on the ground floor that can accommodate the general public.
- Covered Tribunes, technical rooms, cafes and offices.



STADIUM

- 1 STANDARD FOOTBALL FIELD
- 2 ATHLETICS TRACK
- 3 TRIBUNES
- 4 COMMON SPACE





STADIUM



reformsports.com



info@reformsports.com



+90 212 533 70 73

STADIUM

TECHNICAL SPECIFICATIONS

- 14.000m2 Total construction area
- 600m2 indoor area
- 7.140m2 FIFA standards football field
- 1.320 m2 Tartan system running track
- 2000 seating capacity roofed tribunes
- 100 VIP Tribunes,
- 7 Protocol Tribunes
- Goal post and nets
- Corner poles
- Substitute benches
- Referee bench
- Ligthing system
- Led Score Board
- Fire system (Optional)
- Emergency alert system
- Car parking area for 40 cars
- Sound system (Optional)

LIVING AREAS

- Cafeterias
- Fitness center
- Locker rooms
- Referee locker rooms
- Public restrooms
- Disabled restrooms
- Observers and representatives rooms
- Meeting rooms
- Facility supervisor room
- Staff rooms
- Security rooms
- Offices
- UPS room
- Electricity controlling room
- Camera System (Optional)
- Card access control system (Optional)
- Generator (Optional)



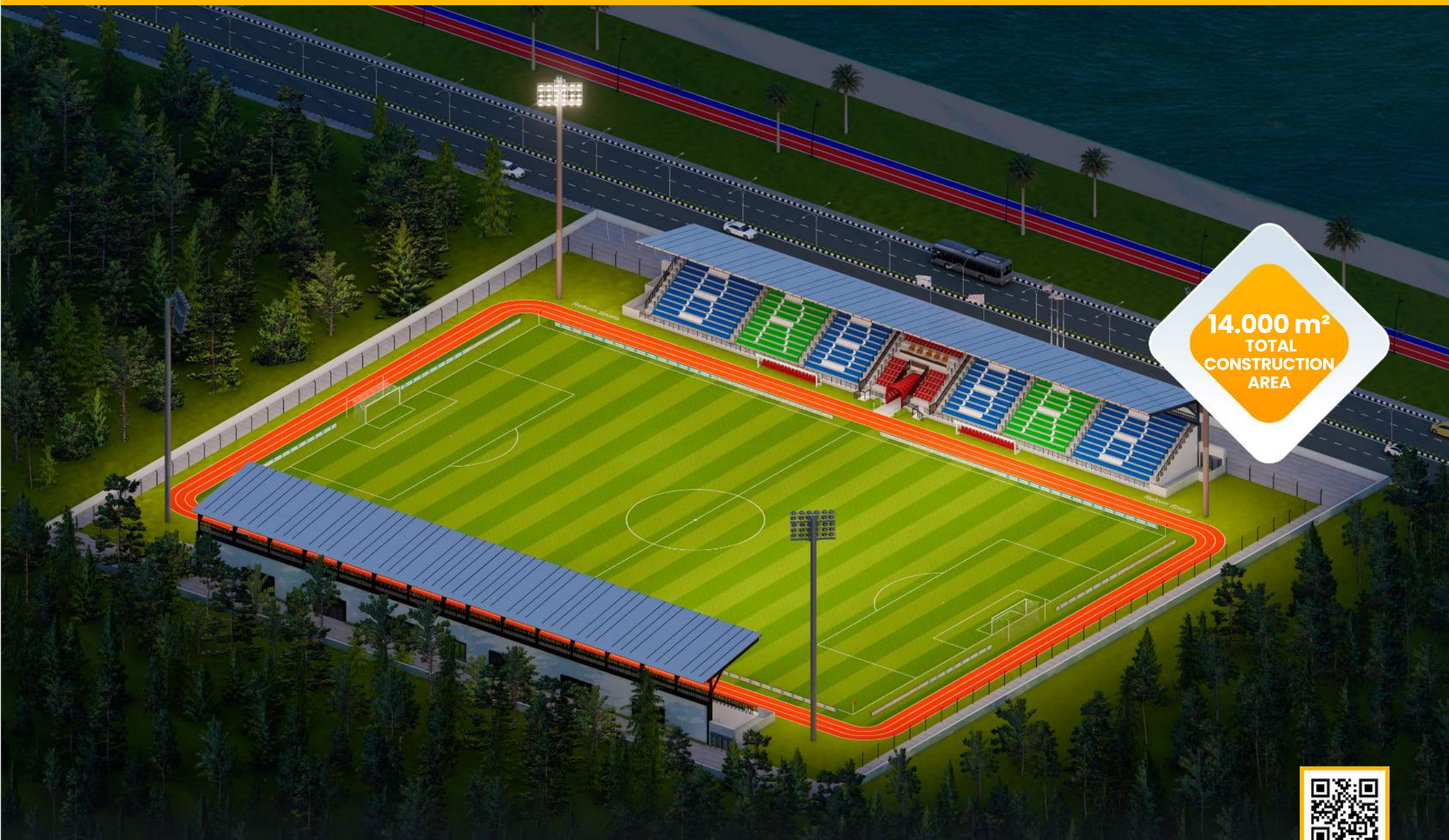

14.000 m²
TOTAL
CONSTRUCTION
AREA



STADIUM



 reformsports.com

 info@reformsports.com

 +90 212 533 70 73



600 m²
INDOOR
AREA



STADIUM



reformsports.com



info@reformsports.com



+90 212 533 70 73



STADIUM



**STANDARD
FOOTBALL FIELD**



reformsports.com



info@reformsports.com



+90 212 533 70 73

High Quality

Our products are produced with the highest quality, ethical standards and in accordance with the international standards



Resistant

Our abrasion and wear resistant products come with different heights, colour options and unique characteristics



Long Lasting

Artificial turfs are easy to maintain and cheap, as well as have a very long life with low maintenance



REFORM SPORTS' synthetic turf is produced with new generation monofilament yarns provides high-quality and provides maximum-performance for training and professional football pitches. Delays wear and tear due to modern yarn design and features. For many years; ball roll and bouncing and shock absorbing values remain in accordance with international standards. It doesn't reduce player's performance, it is environmentally friendly and recyclable

ARTIFICIAL GRASS



Natural Appearance

It is produced with monofilament yarns for aesthetic and more natural appearance



High UV Resistance

It is produced with special UV resistant additive. Besides being resistant to UV rays, it is also resistant to cold weather



Nature Friendly

Our products are manufactured with environmental awareness and consist of recyclable materials with the use of effective technology and components



7.140 m²

STANDARD FOOTBALL FIELD



[reformsports.com](https://www.reformsports.com)



info@reformsports.com



+90 212 533 70 73





**FIFA
STANDARD
ARTIFICIAL
GRASS**



**INTERNATIONAL
MATCH
STANDARD**



STANDARD FOOTBALL FIELD



reformsports.com



info@reformsports.com



+90 212 533 70 73



3 LANES
RUNNING
TRACKS



ATHLETIC TRACK



reformsports.com



info@reformsports.com



+90 212 533 70 73

High Quality

Our products are produced with the highest quality, ethical standards and in accordance with the international standards



Resistant

Our abrasion and wear resistant products come with different heights, colour options and unique characteristics



Long Lasting

Artificial turfs are easy to maintain and cheap, as well as have a very long life with low maintenance



Tartan Ground consists of two layers and water permeable. It is a flexible sports floor which is built with mixture of binder, EPDM and SBR granules. It used on athletics tracks, walking paths, basketball courts, tennis courts, children's playgrounds and indoor sports grounds. It can be used without spoiling for a long time with its structure which is not affected by hot and cold weather conditions



Natural Appearance

It is produced with monofilament yarns for aesthetic and more natural appearance



High UV Resistance

It is produced with special UV resistant additive. Besides being resistant to UV rays, it is also resistant to cold weather



Nature Friendly

Our products are manufactured with environmental awareness and consist of recyclable materials with the use of effective technology and components



TARTAN FLOOR

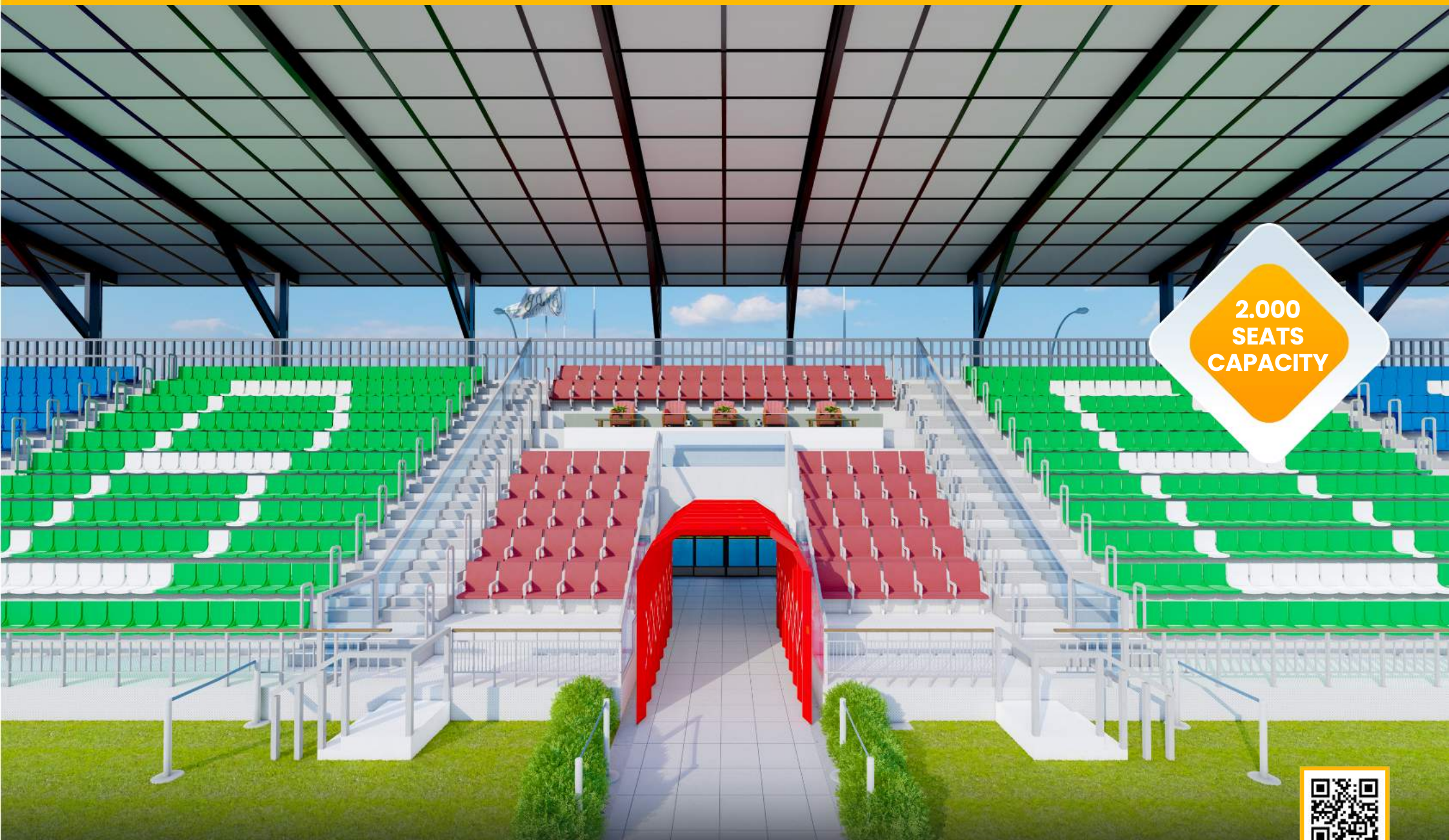

2.000
SEATS
CAPACITY



TRIBUNES

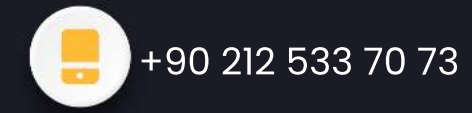



100
VIP
SEATS

ERGONOMIC
DESIGN

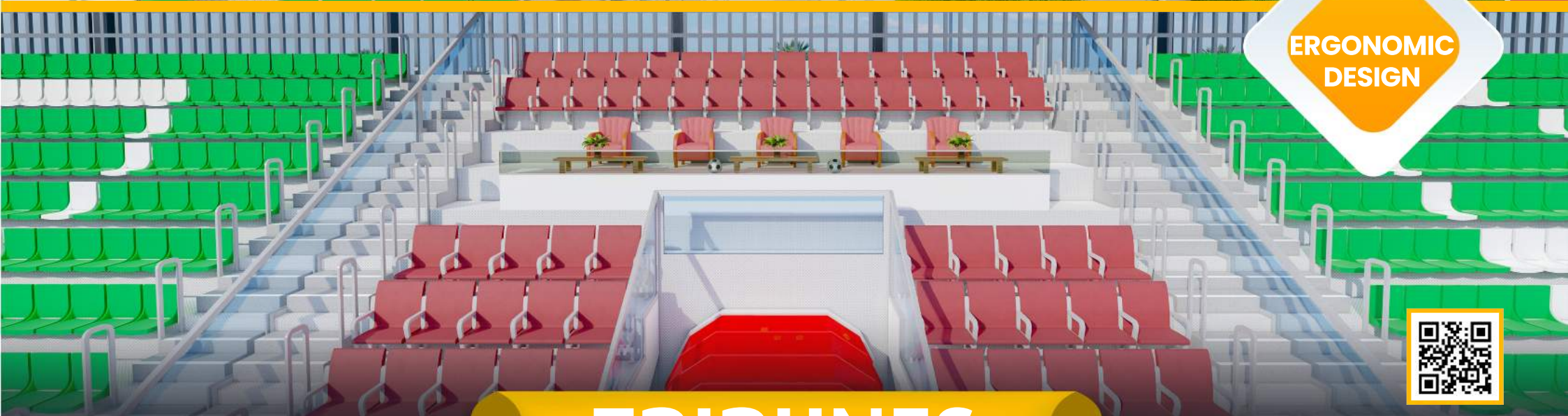

TRIBUNES

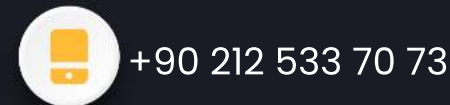
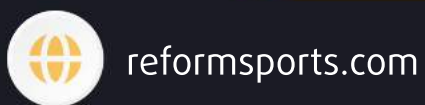



120 m²



INTERIOR

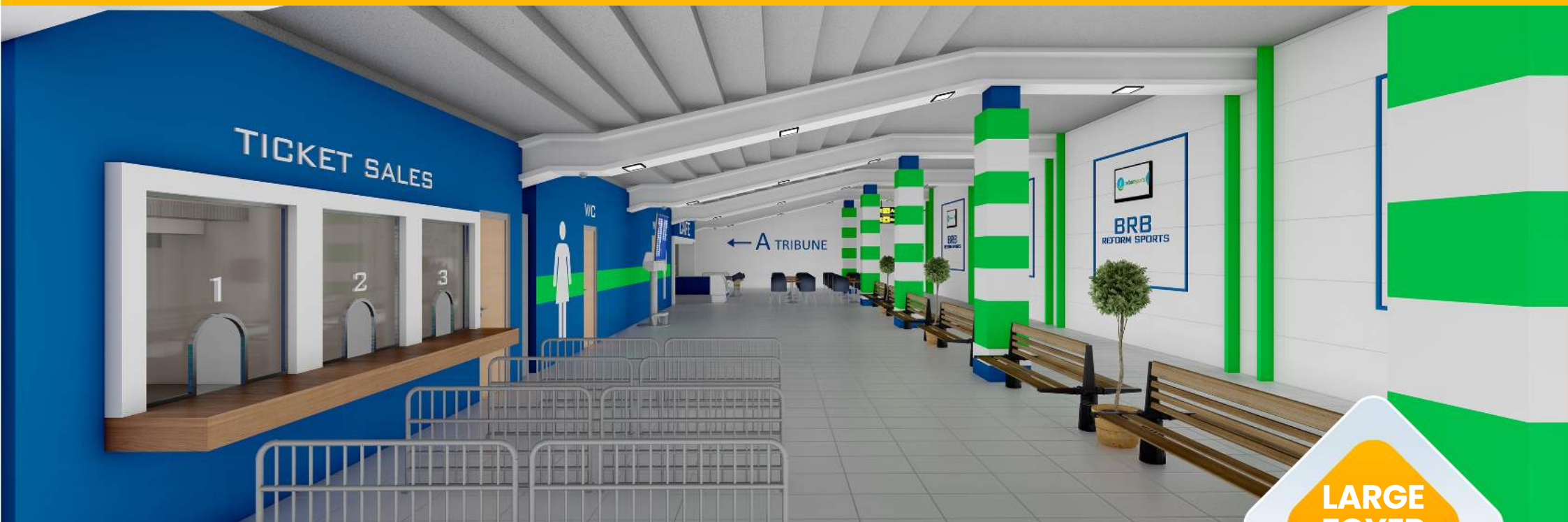

LARGE
FOYER
AREA



INTERIOR

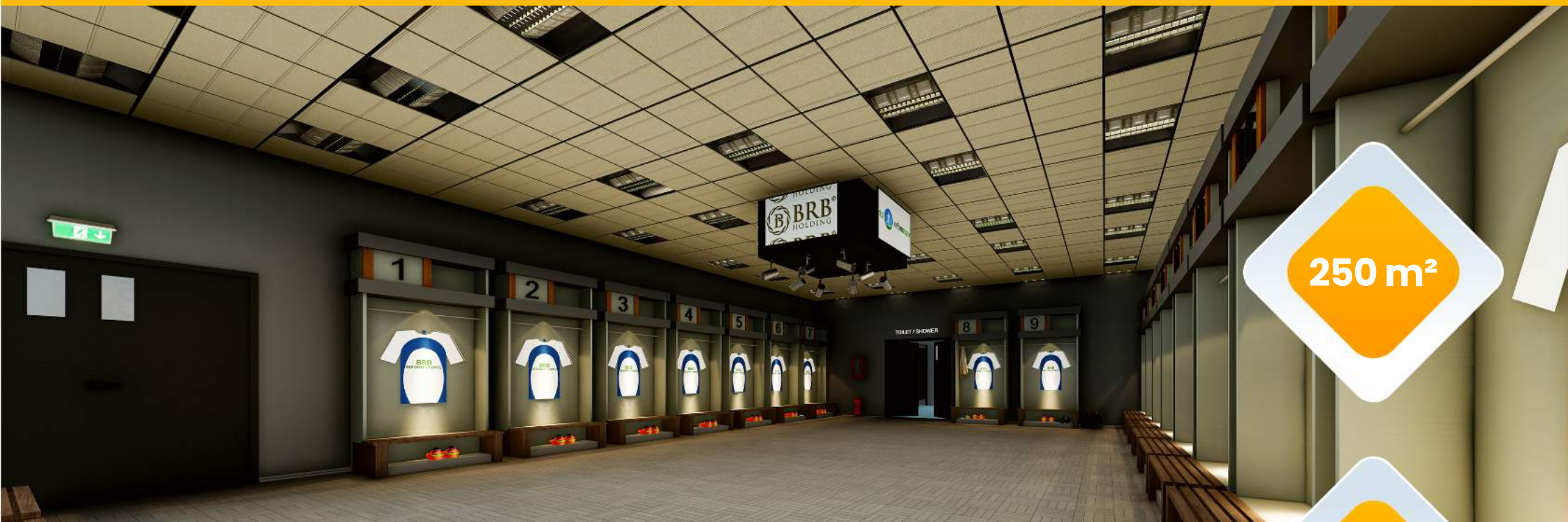

250 m²



2 FOR
TEAMS

LOCKER ROOM

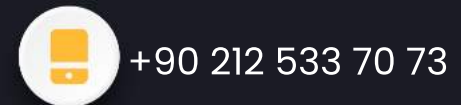
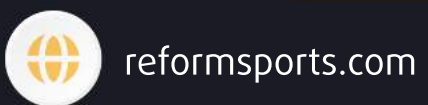



70 m²
FOR
TEAMS



WC & BATHROOM



40 m²

MEDICAL ROOM



reformsports.com



info@reformsports.com



+90 212 533 70 73



80 m²



SPORTS ACADEMY



 reformsports.com

 info@reformsports.com

 +90 212 533 70 73



50 m²



REFEREE ROOM



reformsports.com



info@reformsports.com



+90 212 533 70 73



TECHNICAL DIRECTOR'S ROOM



[reformsports.com](https://www.reformsports.com)



info@reformsports.com



+90 212 533 70 73



100 m²



PRESS AND MEETING ROOM



reformsports.com



info@reformsports.com



+90 212 533 70 73



100 m²



GYM



reformsports.com



info@reformsports.com



+90 212 533 70 73

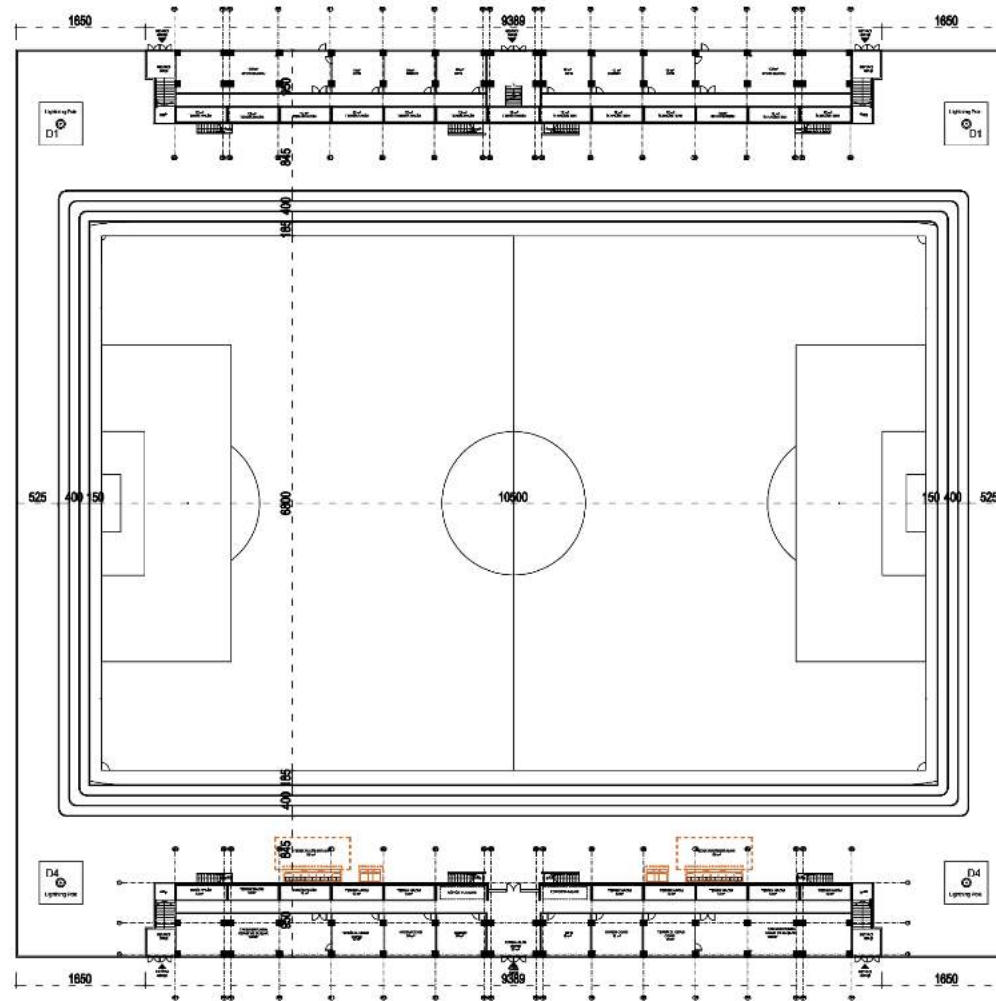

GROUND FLOOR ARCHITECTURAL PLAN



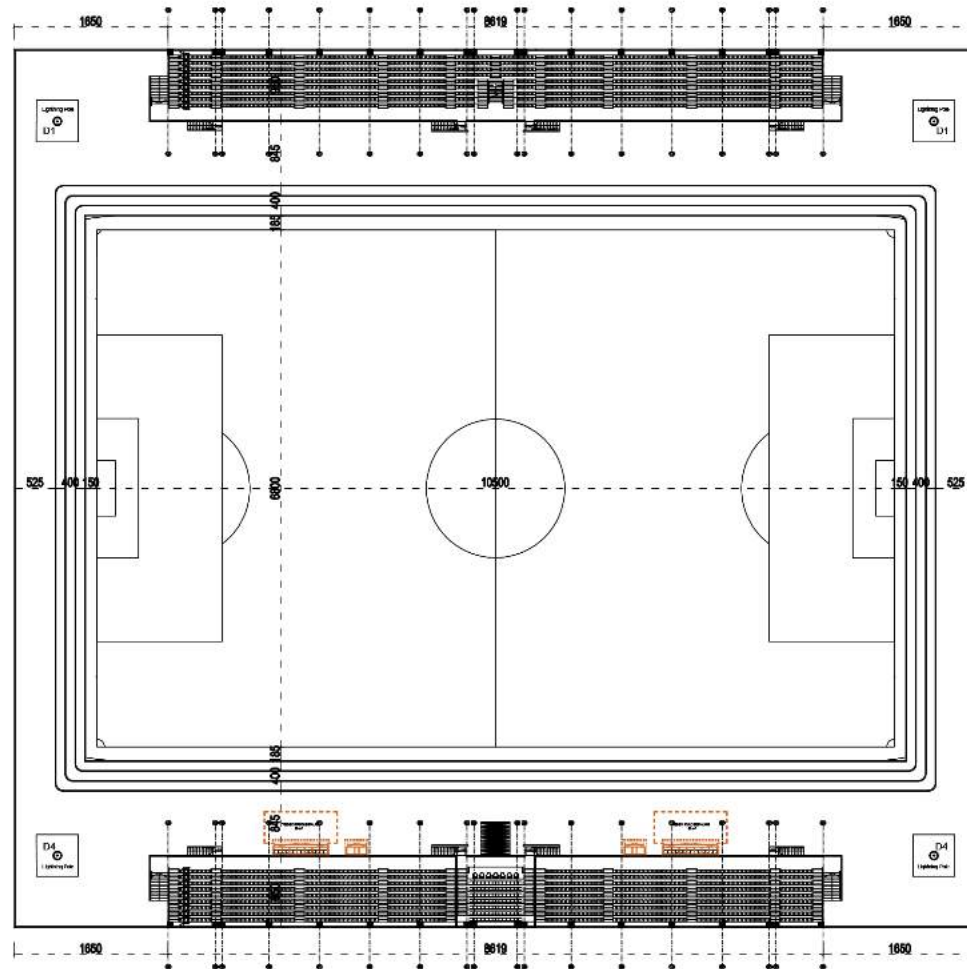

FIRST FLOOR ARCHITECTURAL PLAN



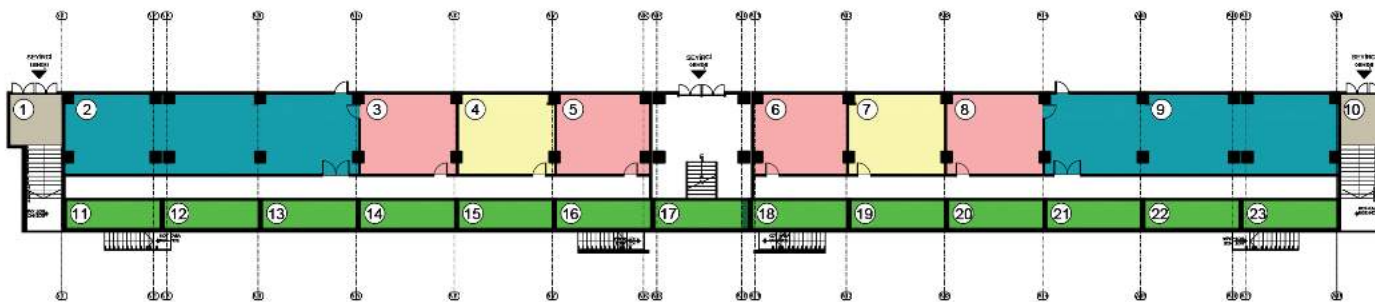

	NUMBER/ NOMBRE	COLOUR/ COULEUR	SQUARE METERS/ MÈTRES CARRÉS	VENUE NAME/ NOM DU SITE		NUMBER/ NOMBRE	COLOUR/ COULEUR	SQUARE METERS/ MÈTRES CARRÉS	VENUE NAME/ NOM DU SITE
	SEYIRCI TRIBÜNÜ	1		11.90 m ²		Audience Entry Entrée du public	SEYIRCI TRIBÜNÜ	15	
2			106.00 m ²	Fitness Center Centre de fitness	16			12.00 m ²	Technical Volume Volume technique
3			19.00 m ²	Office Bureau	17			12.00 m ²	Technical Volume Volume technique
4			19.00 m ²	Technical Volume Volume technique	18			12.00 m ²	Technical Volume Volume technique
5			19.00 m ²	Office Bureau	19			12.00 m ²	Technical Volume Volume technique
6			19.00 m ²	Office Bureau	20			12.00 m ²	Technical Volume Volume technique
7			19.00 m ²	Technical Volume Volume technique	21			12.00 m ²	Technical Volume Volume technique
8			19.00 m ²	Office Bureau	22			12.00 m ²	Technical Volume Volume technique
9			106.00 m ²	Fitness Center Centre de fitness	23			12.00 m ²	Technical Volume Volume technique
10			11.90 m ²	Audience Entry Entrée du public					
	11		12.00 m ²	Technical Volume Volume technique					
	12		12.00 m ²	Technical Volume Volume technique					
	13		12.00 m ²	Technical Volume Volume technique					
	14		12.00 m ²	Technical Volume Volume technique					

TRIBUNES

ARCHITECTURAL PLAN



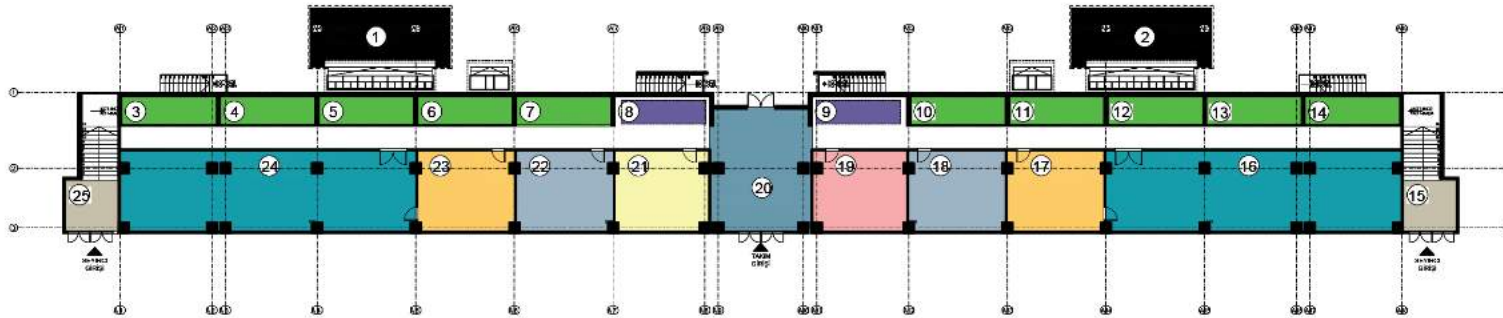

	NUMBER/ NOMBRE	COLOUR/ COULEUR	SQUARE METERS/ MÈTRES CARRÉS	VENUE NAME/ NOM DU SITE		NUMBER/ NOMBRE	COLOUR/ COULEUR	SQUARE METERS/ MÈTRES CARRÉS	VENUE NAME/ NOM DU SITE
MARATON TRIBÜNÜ	1		55.00 m ²	Reserve Bench Area Zone de banc de remplaçant	MARATON TRIBÜNÜ	15		11.90 m ²	Audience Entry Entrée du public
	2		55.00 m ²	Reserve Bench Area Zone de banc de remplaçant		16		106.00 m ²	Team Dressing R- S. Vestiaires et douches de l'équipe
	3		12.00 m ²	Technical Volume Volume technique		17		19.00 m ²	Technical Director's Room salle de carrosse
	4		12.00 m ²	Technical Volume Volume technique		18		19.00 m ²	Referee's Room salle des arbitres
	5		12.00 m ²	Technical Volume Volume technique		19		19.00 m ²	Office Bureau
	6		12.00 m ²	Technical Volume Volume technique		20		55.00 m ²	Mixed Field Karma Alan
	7		12.00 m ²	Technical Volume Volume technique		21		19.00 m ²	Technical Volume Volume technique
	8		12.00 m ²	Interview Area Zone de reportage		22		19.00 m ²	Referee's Room salle des arbitres
	9		12.00 m ²	Interview Area Zone de reportage		23		19.00 m ²	Technical Director's Room salle de carrosse
	10		12.00 m ²	Technical Volume Volume technique		24		106.00 m ²	Team Dressing R- S. Vestiaires et douches de l'équipe
	11		12.00 m ²	Technical Volume Volume technique		25		11.90 m ²	Audience Entry Entrée du public
	12		12.00 m ²	Technical Volume Volume technique					
	13		12.00 m ²	Technical Volume Volume technique					
	14		12.00 m ²	Technical Volume Volume technique					

TRIBUNES

ARCHITECTURAL PLAN



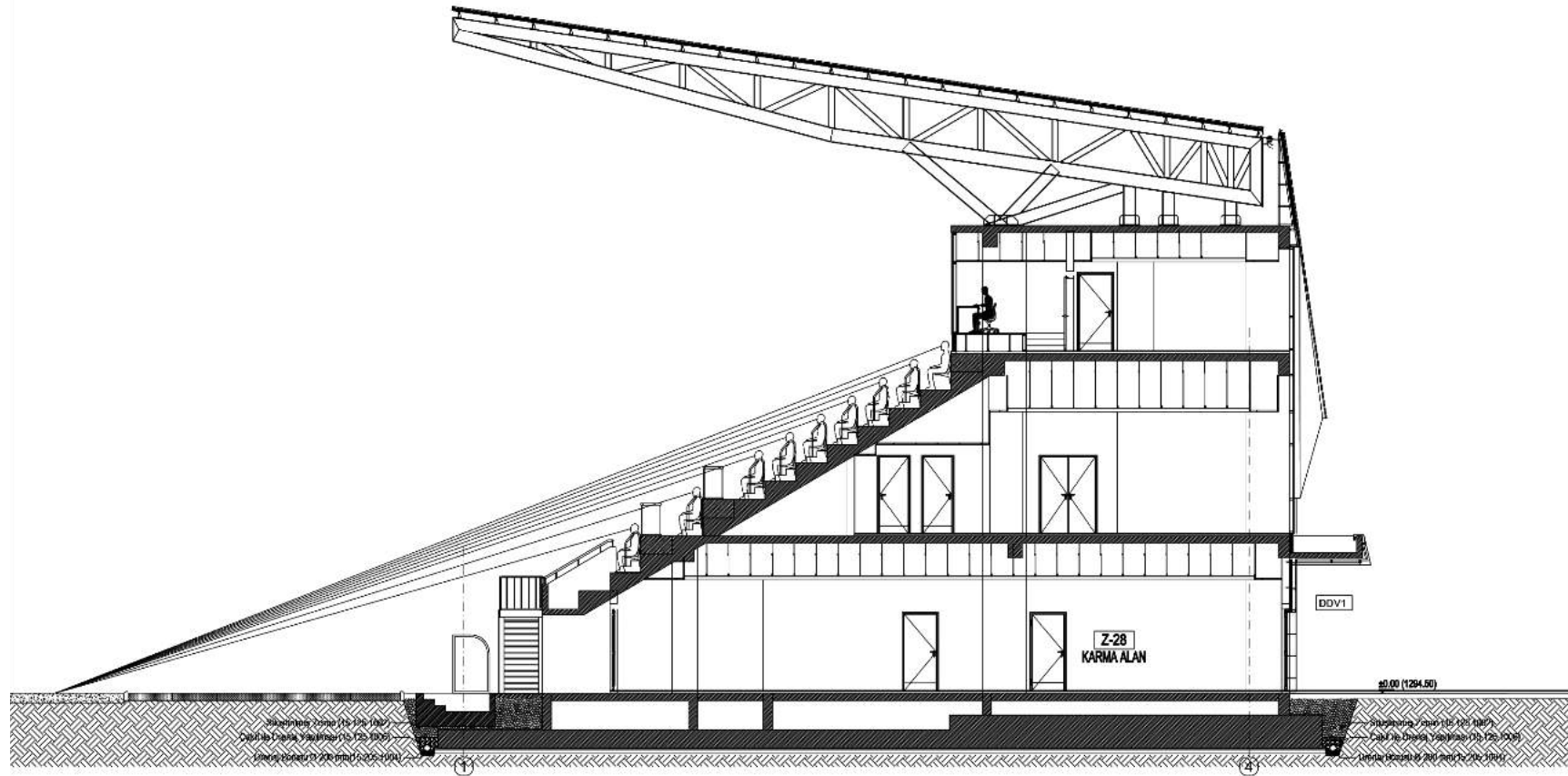

TRIBUNES

ARCHITECTURAL PLAN



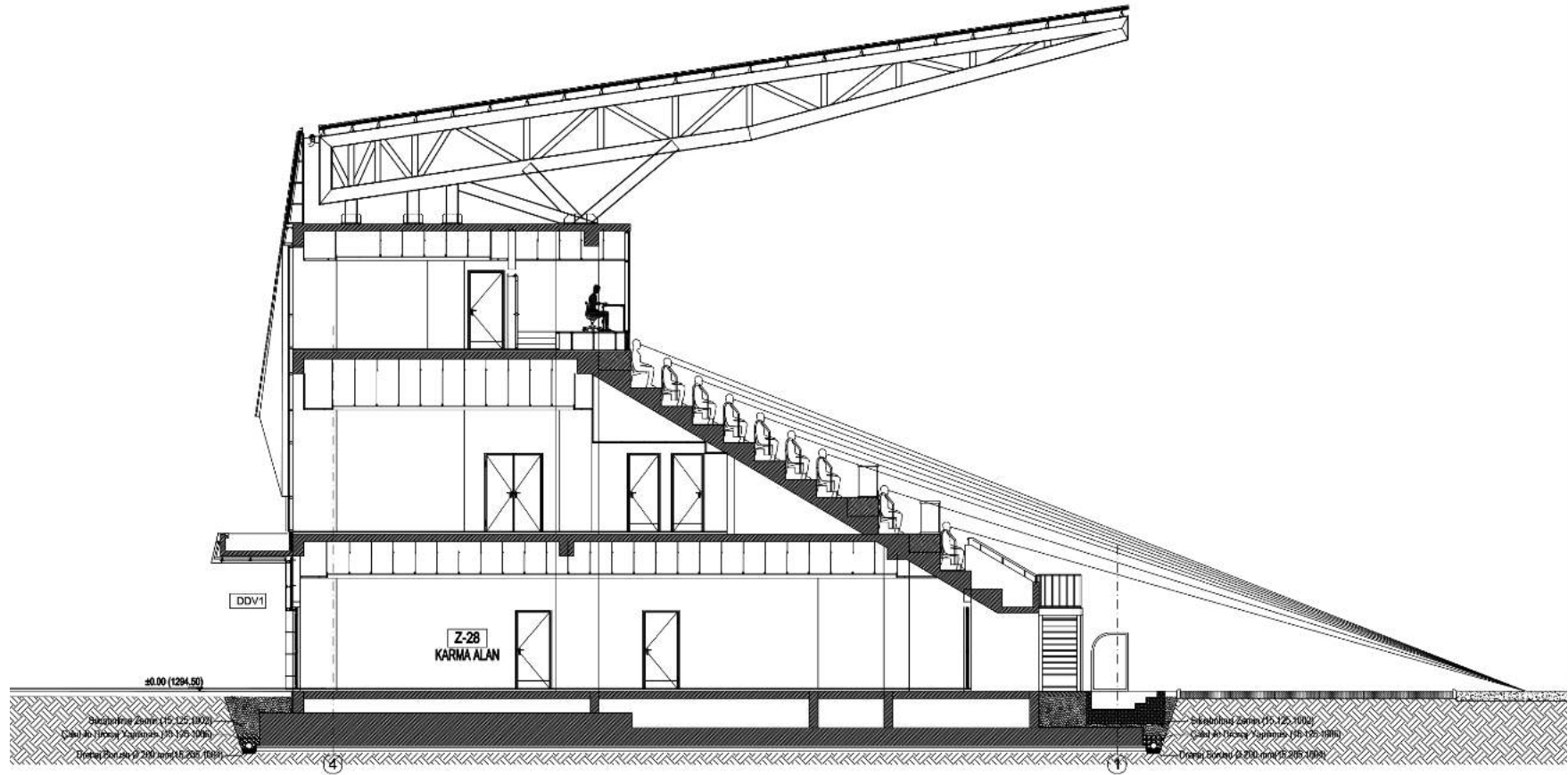

TRIBUNES

ARCHITECTURAL PLAN





reform[®]
sports



www.reformsports.com